

---

---

First published in the *Government Gazette*, Electronic Edition, on 31 March 2021 at 5 pm.

## No. S 196

### INFRASTRUCTURE PROTECTION ACT 2017 (ACT 41 OF 2017)

#### INFRASTRUCTURE PROTECTION (PROTECTED PLACES) (NO. 3) ORDER 2021

##### ARRANGEMENT OF PARAGRAPHS

###### Paragraph

1. Citation and commencement
  2. Premises declared to be protected places  
The Schedule
- 

In exercise of the powers conferred by section 14(1) of the Infrastructure Protection Act 2017, the Minister for Home Affairs makes the following Order:

#### **Citation and commencement**

1. This Order is the Infrastructure Protection (Protected Places) (No. 3) Order 2021 and comes into operation on 1 April 2021.

#### **Premises declared to be protected places**

2. The premises described in the second column of the Schedule are declared to be protected places for the purposes of the Act, and the person specified in the first column of that Schedule is designated as the authority of the corresponding protected place.

---



---

THE SCHEDULE

Paragraph 2

<i>First column</i>	<i>Second column</i>																																
The Authority	Protected Place																																
1. Head, Bus Depot, SBS Transit Ltd	<p>(1) ANG MO KIO BUS DEPOT</p> <p>All that area comprised in Land Lot 08734L in Mukim No. 18 occupied by “ANG MO KIO BUS DEPOT” containing an area of about 69955.0 square metres and bounded approximately as follows:</p> <p>Commencing at the easternmost corner of the perimeter fence and wall of the Land Lot 08734L in Mukim No. 18 at a point 41046.894 metres North and 29628.207 metres East of the Singapore Land Authority SVY 21 Datum, the boundaries run along successive lines of coordinates approximately as follows:</p> <table border="0" style="margin-left: 40px;"> <thead> <tr> <th style="text-align: left;"><i>Northing</i></th> <th style="text-align: left;"><i>Easting</i></th> </tr> </thead> <tbody> <tr><td>41046.894</td><td>29628.207</td></tr> <tr><td>41052.510</td><td>29620.051</td></tr> <tr><td>41012.205</td><td>29463.660</td></tr> <tr><td>40978.040</td><td>29331.070</td></tr> <tr><td>40959.398</td><td>29341.131</td></tr> <tr><td>40867.561</td><td>29394.556</td></tr> <tr><td>40856.661</td><td>29400.637</td></tr> <tr><td>40845.553</td><td>29406.331</td></tr> <tr><td>40834.244</td><td>29411.621</td></tr> <tr><td>40822.758</td><td>29416.502</td></tr> <tr><td>40802.137</td><td>29424.841</td></tr> <tr><td>40788.207</td><td>29429.675</td></tr> <tr><td>40773.862</td><td>29433.079</td></tr> <tr><td>40768.276</td><td>29433.823</td></tr> <tr><td>40771.923</td><td>29495.427</td></tr> </tbody> </table>	<i>Northing</i>	<i>Easting</i>	41046.894	29628.207	41052.510	29620.051	41012.205	29463.660	40978.040	29331.070	40959.398	29341.131	40867.561	29394.556	40856.661	29400.637	40845.553	29406.331	40834.244	29411.621	40822.758	29416.502	40802.137	29424.841	40788.207	29429.675	40773.862	29433.079	40768.276	29433.823	40771.923	29495.427
<i>Northing</i>	<i>Easting</i>																																
41046.894	29628.207																																
41052.510	29620.051																																
41012.205	29463.660																																
40978.040	29331.070																																
40959.398	29341.131																																
40867.561	29394.556																																
40856.661	29400.637																																
40845.553	29406.331																																
40834.244	29411.621																																
40822.758	29416.502																																
40802.137	29424.841																																
40788.207	29429.675																																
40773.862	29433.079																																
40768.276	29433.823																																
40771.923	29495.427																																

---



---

 THE SCHEDULE — *continued*

<i>First column</i>	<i>Second column</i>	
The Authority	Protected Place	
	40775.385	29553.969
	40780.596	29642.311
	40782.435	29642.619
	40808.078	29645.591
	40833.834	29647.230
	40859.639	29647.542
	40885.422	29646.519
	40911.123	29644.165

to the point of commencement.

The boundaries of “ANG MO KIO BUS DEPOT” are more particularly delineated in the Survey Plan No. LTA/PP/GAZ/SBST/AMKBD filed in the office of the Deputy Director, Public Transport Security Division, Land Transport Authority of Singapore, a copy of which is set out below.

THE SCHEDULE — *continued*

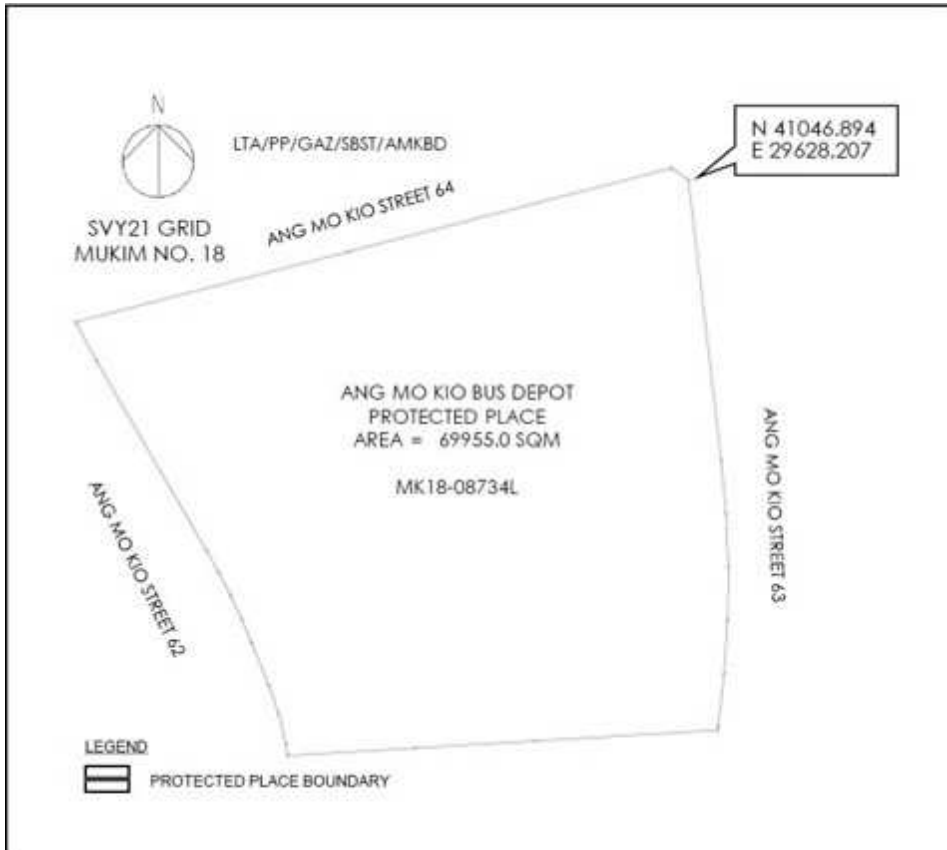

THE SCHEDULE — *continued*

<i>First column</i>	<i>Second column</i>																																
The Authority Head, Bus Depot, SBS Transit Ltd	Protected Place  (2) BEDOK NORTH BUS DEPOT  All that area comprised in Land Lot 02434M in Mukim No. 28 occupied by “BEDOK NORTH BUS DEPOT” containing an area of about 62219.9 square metres and bounded approximately as follows:  Commencing at the easternmost corner of the perimeter fence and wall of the Land Lot 02434M in Mukim No. 28 at a point 35664.105 metres North and 40839.765 metres East of the Singapore Land Authority SVY 21 Datum, the boundaries run along successive lines of coordinates approximately as follows:																																
	<table border="0" style="margin-left: auto; margin-right: auto;"> <thead> <tr> <th style="text-align: left;"><i>Northing</i></th> <th style="text-align: left;"><i>Easting</i></th> </tr> </thead> <tbody> <tr><td>35664.105</td><td>40839.765</td></tr> <tr><td>35682.168</td><td>40825.372</td></tr> <tr><td>35689.816</td><td>40738.796</td></tr> <tr><td>35706.026</td><td>40555.306</td></tr> <tr><td>35754.155</td><td>40514.910</td></tr> <tr><td>35750.169</td><td>40511.786</td></tr> <tr><td>35744.125</td><td>40505.851</td></tr> <tr><td>35738.849</td><td>40498.901</td></tr> <tr><td>35734.827</td><td>40491.003</td></tr> <tr><td>35703.236</td><td>40395.725</td></tr> <tr><td>35700.071</td><td>40387.425</td></tr> <tr><td>35696.104</td><td>40379.450</td></tr> <tr><td>35691.547</td><td>40371.751</td></tr> <tr><td>35690.344</td><td>40370.304</td></tr> <tr><td>35645.026</td><td>40408.274</td></tr> </tbody> </table>	<i>Northing</i>	<i>Easting</i>	35664.105	40839.765	35682.168	40825.372	35689.816	40738.796	35706.026	40555.306	35754.155	40514.910	35750.169	40511.786	35744.125	40505.851	35738.849	40498.901	35734.827	40491.003	35703.236	40395.725	35700.071	40387.425	35696.104	40379.450	35691.547	40371.751	35690.344	40370.304	35645.026	40408.274
<i>Northing</i>	<i>Easting</i>																																
35664.105	40839.765																																
35682.168	40825.372																																
35689.816	40738.796																																
35706.026	40555.306																																
35754.155	40514.910																																
35750.169	40511.786																																
35744.125	40505.851																																
35738.849	40498.901																																
35734.827	40491.003																																
35703.236	40395.725																																
35700.071	40387.425																																
35696.104	40379.450																																
35691.547	40371.751																																
35690.344	40370.304																																
35645.026	40408.274																																

THE SCHEDULE — *continued*

<i>First column</i>		<i>Second column</i>
The Authority		Protected Place
	35629.556	40389.813
	35541.344	40463.799
	35540.578	40464.442
	35540.345	40464.638
	35550.680	40476.987
	35551.994	40478.713
	35556.281	40484.342
	35560.950	40492.317
	35564.770	40500.747
	35567.487	40509.578
	35569.303	40518.636
	35570.110	40527.851
	35570.263	40542.717
	35569.684	40557.606
	35568.088	40572.407
	35566.112	40587.155
	35552.062	40672.171
	35544.473	40716.537
	35543.636	40721.426
	35540.333	40736.010
	35535.376	40750.088
	35528.606	40763.388
	35523.904	40771.246

to the point of commencement.

THE SCHEDULE — *continued**First column*

The Authority

*Second column*

Protected Place

The boundaries of “BEDOK NORTH BUS DEPOT” are more particularly delineated in the Survey Plan No. LTA/PP/GAZ/SBST/AMKBD filed in the office of the Deputy Director, Public Transport Security Division, Land Transport Authority of Singapore, a copy of which is set out below.

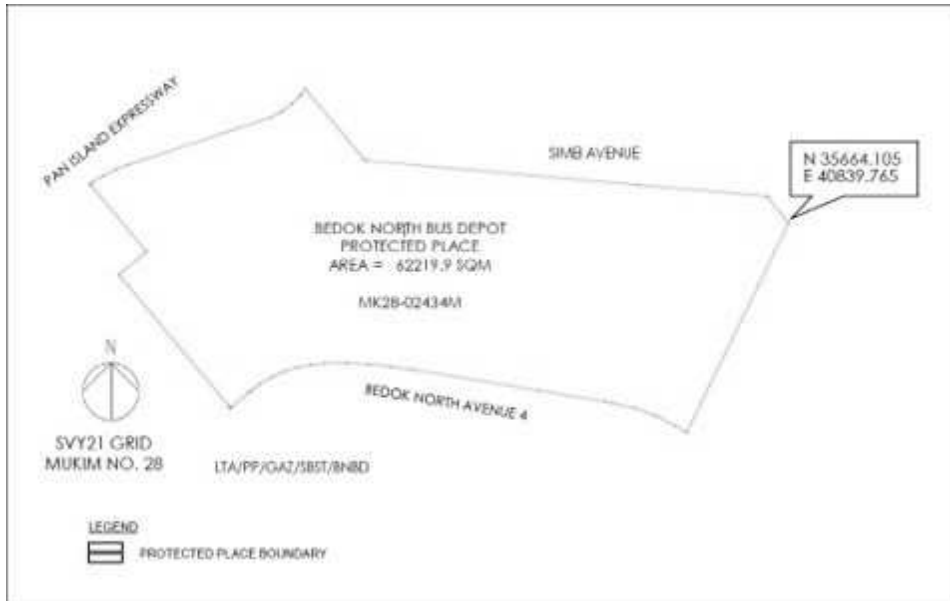

THE SCHEDULE — *continued*

<i>First column</i>	<i>Second column</i>																												
The Authority	Protected Place																												
Head, Bus Depot, SBS Transit Ltd	<p>(3) BUKIT BATOK BUS DEPOT</p> <p>All that area comprised in Land Lot 04316M in Mukim No. 05 occupied by “BUKIT BATOK BUS DEPOT” containing an area of about 52189.0 square metres and bounded approximately as follows:</p> <p>Commencing at the westernmost corner of the perimeter fence and wall of the Land Lot 04316M in Mukim No. 05 at a point 35790.122 metres North and 19009.691 metres East of the Singapore Land Authority SVY 21 Datum, the boundaries run along successive lines of coordinates approximately as follows:</p> <table border="0" style="margin-left: auto; margin-right: auto;"> <thead> <tr> <th style="text-align: center;"><i>Northing</i></th> <th style="text-align: center;"><i>Easting</i></th> </tr> </thead> <tbody> <tr><td style="text-align: center;">35790.122</td><td style="text-align: center;">19009.691</td></tr> <tr><td style="text-align: center;">35771.934</td><td style="text-align: center;">19041.679</td></tr> <tr><td style="text-align: center;">35760.943</td><td style="text-align: center;">19061.198</td></tr> <tr><td style="text-align: center;">35737.641</td><td style="text-align: center;">19082.303</td></tr> <tr><td style="text-align: center;">35642.973</td><td style="text-align: center;">19250.631</td></tr> <tr><td style="text-align: center;">35660.354</td><td style="text-align: center;">19260.668</td></tr> <tr><td style="text-align: center;">35846.203</td><td style="text-align: center;">19365.127</td></tr> <tr><td style="text-align: center;">35927.084</td><td style="text-align: center;">19221.403</td></tr> <tr><td style="text-align: center;">35920.674</td><td style="text-align: center;">19212.803</td></tr> <tr><td style="text-align: center;">35899.926</td><td style="text-align: center;">19177.220</td></tr> <tr><td style="text-align: center;">35885.486</td><td style="text-align: center;">19153.397</td></tr> <tr><td style="text-align: center;">35877.070</td><td style="text-align: center;">19139.276</td></tr> <tr><td style="text-align: center;">35866.867</td><td style="text-align: center;">19122.393</td></tr> </tbody> </table>	<i>Northing</i>	<i>Easting</i>	35790.122	19009.691	35771.934	19041.679	35760.943	19061.198	35737.641	19082.303	35642.973	19250.631	35660.354	19260.668	35846.203	19365.127	35927.084	19221.403	35920.674	19212.803	35899.926	19177.220	35885.486	19153.397	35877.070	19139.276	35866.867	19122.393
<i>Northing</i>	<i>Easting</i>																												
35790.122	19009.691																												
35771.934	19041.679																												
35760.943	19061.198																												
35737.641	19082.303																												
35642.973	19250.631																												
35660.354	19260.668																												
35846.203	19365.127																												
35927.084	19221.403																												
35920.674	19212.803																												
35899.926	19177.220																												
35885.486	19153.397																												
35877.070	19139.276																												
35866.867	19122.393																												

THE SCHEDULE — *continued*

<i>First column</i>	<i>Second column</i>	
The Authority	Protected Place	
	35800.985	19029.916
	35795.767	19020.233

to the point of commencement.

The boundaries of “BUKIT BATOK BUS DEPOT” are more particularly delineated in the Survey Plan No. LTA/PP/GAZ/SBST/BBBD filed in the office of the Deputy Director, Public Transport Security Division, Land Transport Authority of Singapore, a copy of which is set out below.

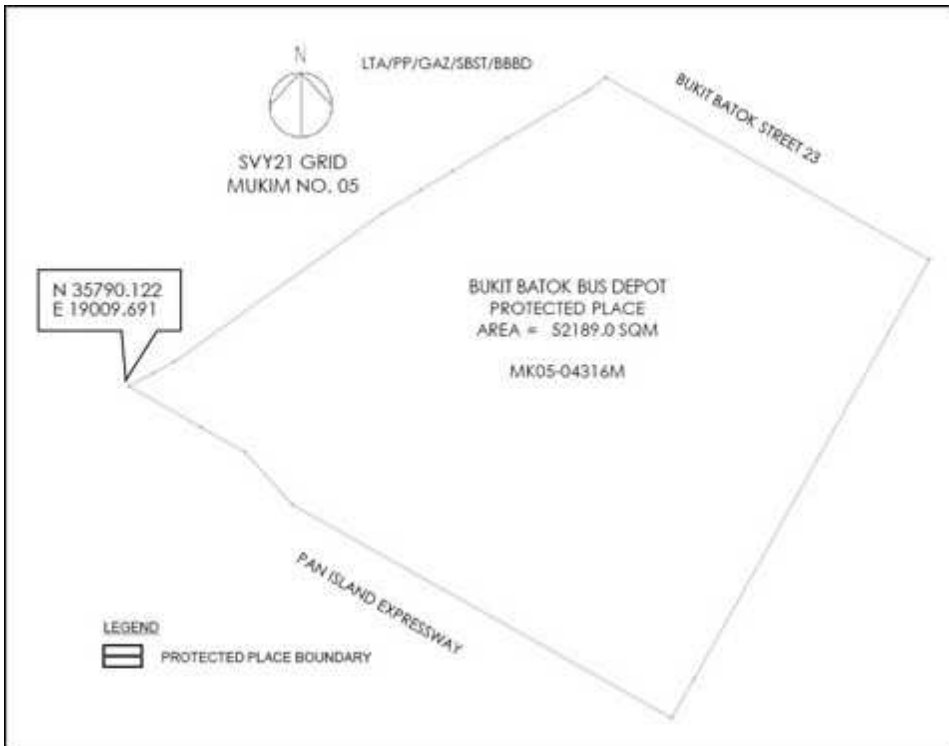

THE SCHEDULE — *continued*

<i>First column</i>	<i>Second column</i>																																
The Authority Head, Bus Depot, SBS Transit Ltd	Protected Place  (4) HOUGANG BUS DEPOT  All that area comprised in Land Lot 05874A in Mukim No. 23 occupied by “HOUGANG BUS DEPOT” containing an area of about 74238.4 square metres and bounded approximately as follows:  Commencing at the easternmost corner of the perimeter fence and wall of the Land Lot 05874A in Mukim No. 23 at a point 36507.057 metres North and 34771.563 metres East of the Singapore Land Authority SVY 21 Datum, the boundaries run along successive lines of coordinates approximately as follows:																																
	<table border="0" style="margin-left: auto; margin-right: auto;"> <thead> <tr> <th style="text-align: left;"><i>Northing</i></th> <th style="text-align: left;"><i>Easting</i></th> </tr> </thead> <tbody> <tr><td>36507.057</td><td>34771.563</td></tr> <tr><td>36543.335</td><td>34729.535</td></tr> <tr><td>36605.949</td><td>34711.689</td></tr> <tr><td>36584.640</td><td>34646.713</td></tr> <tr><td>36556.590</td><td>34561.179</td></tr> <tr><td>36552.448</td><td>34562.006</td></tr> <tr><td>36542.813</td><td>34563.289</td></tr> <tr><td>36533.092</td><td>34563.329</td></tr> <tr><td>36523.445</td><td>34562.121</td></tr> <tr><td>36514.034</td><td>34559.687</td></tr> <tr><td>36505.011</td><td>34556.068</td></tr> <tr><td>36496.525</td><td>34551.323</td></tr> <tr><td>36488.719</td><td>34545.529</td></tr> <tr><td>36481.722</td><td>34538.780</td></tr> <tr><td>36475.601</td><td>34531.198</td></tr> </tbody> </table>	<i>Northing</i>	<i>Easting</i>	36507.057	34771.563	36543.335	34729.535	36605.949	34711.689	36584.640	34646.713	36556.590	34561.179	36552.448	34562.006	36542.813	34563.289	36533.092	34563.329	36523.445	34562.121	36514.034	34559.687	36505.011	34556.068	36496.525	34551.323	36488.719	34545.529	36481.722	34538.780	36475.601	34531.198
<i>Northing</i>	<i>Easting</i>																																
36507.057	34771.563																																
36543.335	34729.535																																
36605.949	34711.689																																
36584.640	34646.713																																
36556.590	34561.179																																
36552.448	34562.006																																
36542.813	34563.289																																
36533.092	34563.329																																
36523.445	34562.121																																
36514.034	34559.687																																
36505.011	34556.068																																
36496.525	34551.323																																
36488.719	34545.529																																
36481.722	34538.780																																
36475.601	34531.198																																

---



---

 THE SCHEDULE — *continued*

<i>First column</i>	<i>Second column</i>
The Authority	Protected Place
36470.589	34522.890
36466.640	34514.008
36463.860	34504.693
36444.500	34425.619
36435.875	34421.361
36394.875	34430.858
36366.120	34442.359
36352.157	34445.341
36323.649	34447.215
36312.945	34449.669
36284.729	34460.001
36219.976	34474.938
36214.116	34476.877
36208.719	34479.858
36203.963	34483.781
36200.010	34488.513
36196.996	34493.891
36195.024	34499.732
36194.404	34504.102
36196.459	34522.435
36197.293	34541.423
36196.841	34560.422
36194.987	34579.654
36196.648	34583.399
36206.906	34602.887
36218.454	34621.639
36223.607	34628.831

THE SCHEDULE — *continued*

<i>First column</i>	<i>Second column</i>
The Authority	Protected Place
36317.985	34607.168
36391.970	34671.498
36411.070	34687.958

to the point of commencement.

The boundaries of “HOUGANG BUS DEPOT” are more particularly delineated in the Survey Plan No. LTA/PP/GAZ/SBST/HGBD filed in the office of the Deputy Director, Public Transport Security Division, Land Transport Authority of Singapore, a copy of which is set out below.

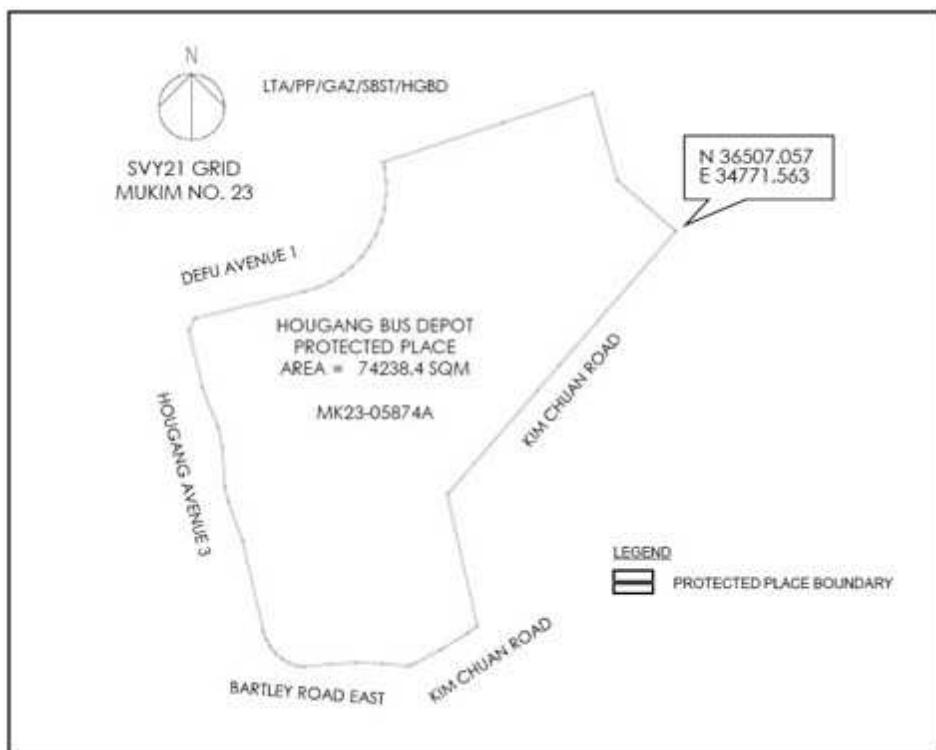

THE SCHEDULE — *continued*

<i>First column</i>	<i>Second column</i>																																
The Authority	Protected Place																																
Head, Bus Depot, SBS Transit Ltd	<p>(5) SELETAR BUS DEPOT</p> <p>All that area comprised in part of State Land Lots 03865M, 04234A, 04238L, 03873A, 04240X, 01285P, 04019V, 01290A and 03718T in Mukim No. 20 occupied by “SELETAR BUS DEPOT” containing an area of about 95251.6 square metres and bounded approximately as follows:</p> <p>Commencing at the westernmost corner of the perimeter fence and wall of the State Land Lot 03865M in Mukim No. 20 at a point 41834.2 metres North and 28355.8 metres East of the Singapore Land Authority SVY 21 Datum, the boundaries run along successive lines of coordinates approximately as follows:</p> <table border="0" style="margin-left: 40px;"> <thead> <tr> <th style="text-align: left;"><i>Northing</i></th> <th style="text-align: left;"><i>Easting</i></th> </tr> </thead> <tbody> <tr><td>41834.2</td><td>28355.8</td></tr> <tr><td>41850.3</td><td>28406.7</td></tr> <tr><td>41852.3</td><td>28413.7</td></tr> <tr><td>41859.4</td><td>28439.5</td></tr> <tr><td>41870.0</td><td>28481.9</td></tr> <tr><td>41880.2</td><td>28521.9</td></tr> <tr><td>41888.0</td><td>28552.1</td></tr> <tr><td>41900.0</td><td>28594.1</td></tr> <tr><td>41896.3</td><td>28607.4</td></tr> <tr><td>41899.9</td><td>28621.5</td></tr> <tr><td>41900.4</td><td>28622.3</td></tr> <tr><td>41909.8</td><td>28631.7</td></tr> <tr><td>41919.3</td><td>28669.3</td></tr> <tr><td>41928.3</td><td>28705.2</td></tr> <tr><td>41920.8</td><td>28723.2</td></tr> </tbody> </table>	<i>Northing</i>	<i>Easting</i>	41834.2	28355.8	41850.3	28406.7	41852.3	28413.7	41859.4	28439.5	41870.0	28481.9	41880.2	28521.9	41888.0	28552.1	41900.0	28594.1	41896.3	28607.4	41899.9	28621.5	41900.4	28622.3	41909.8	28631.7	41919.3	28669.3	41928.3	28705.2	41920.8	28723.2
<i>Northing</i>	<i>Easting</i>																																
41834.2	28355.8																																
41850.3	28406.7																																
41852.3	28413.7																																
41859.4	28439.5																																
41870.0	28481.9																																
41880.2	28521.9																																
41888.0	28552.1																																
41900.0	28594.1																																
41896.3	28607.4																																
41899.9	28621.5																																
41900.4	28622.3																																
41909.8	28631.7																																
41919.3	28669.3																																
41928.3	28705.2																																
41920.8	28723.2																																

THE SCHEDULE — *continued*

<i>First column</i>		<i>Second column</i>
The Authority		Protected Place
	41869.8	28745.8
	41814.4	28770.5
	41754.5	28797.3
	41703.8	28819.9
	41682.1	28824.3
	41679.8	28815.5
	41675.8	28800.5
	41673.1	28790.1
	41672.7	28788.5
	41668.7	28773.1
	41663.9	28754.8
	41660.4	28741.6
	41648.8	28697.0
	41640.7	28665.9
	41629.5	28622.6
	41627.8	28616.0
	41625.8	28608.5
	41622.2	28595.1
	41618.1	28579.1
	41615.6	28569.3
	41615.1	28567.8
	41605.8	28532.1
	41606.5	28530.5
	41607.7	28528.4
	41608.9	28526.3
	41627.9	28495.2
	41644.2	28468.5

THE SCHEDULE — *continued*

<i>First column</i>	<i>Second column</i>
The Authority	Protected Place
41681.8	28446.2
41717.3	28425.2
41769.5	28394.1

to the point of commencement.

The boundaries of “SELETAR BUS DEPOT” are more particularly delineated in the Survey Plan No. LTA/PP/GAZ/LTA/SLBD filed in the office of the Deputy Director, Public Transport Security Division, Land Transport Authority of Singapore, a copy of which is set out below.

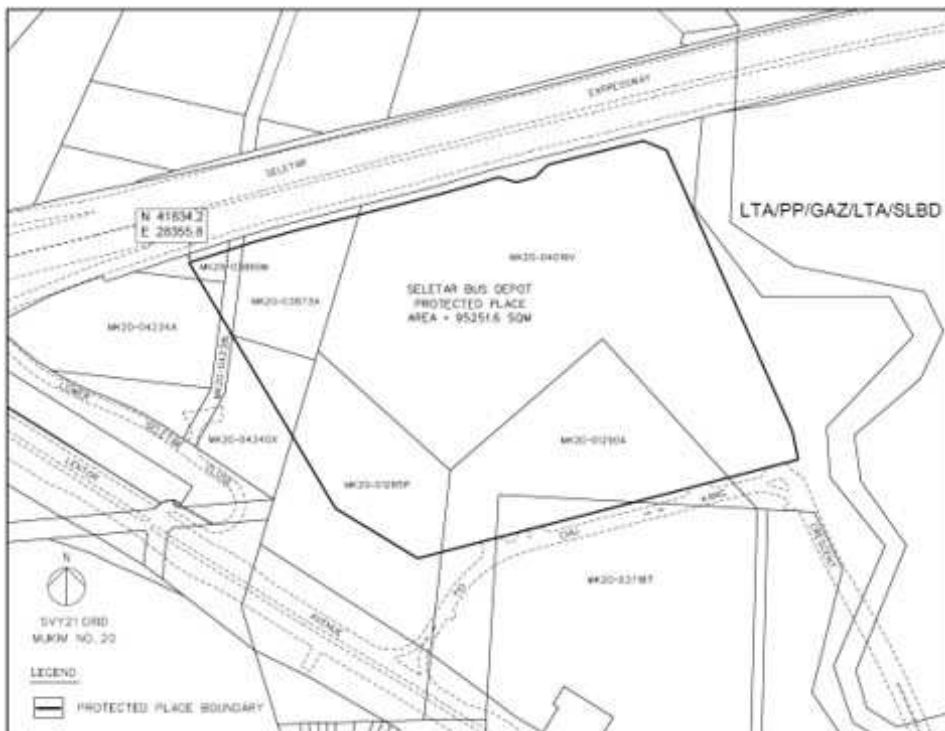

THE SCHEDULE — *continued*

<i>First column</i>	<i>Second column</i>																				
The Authority	Protected Place																				
Head, Bus Depot, SBS Transit Ltd	(6) SOON LEE BUS DEPOT  All that area comprised in Land Lot 03682K in Mukim No. 06 occupied by “SOON LEE BUS DEPOT” containing an area of about 26671.2 square metres and bounded approximately as follows:  Commencing at the westernmost corner of the perimeter fence and wall of the Land Lot 03682K in Mukim No. 06 at a point 34706.340 metres North and 12979.403 metres East of the Singapore Land Authority SVY 21 Datum, the boundaries run along successive lines of coordinates approximately as follows:  <table border="0" style="margin-left: auto; margin-right: auto;"> <thead> <tr> <th style="text-align: center;"><i>Northing</i></th> <th style="text-align: center;"><i>Easting</i></th> </tr> </thead> <tbody> <tr><td style="text-align: center;">34706.340</td><td style="text-align: center;">12979.403</td></tr> <tr><td style="text-align: center;">34809.108</td><td style="text-align: center;">12979.316</td></tr> <tr><td style="text-align: center;">34909.107</td><td style="text-align: center;">12979.231</td></tr> <tr><td style="text-align: center;">34918.251</td><td style="text-align: center;">12969.204</td></tr> <tr><td style="text-align: center;">34918.257</td><td style="text-align: center;">12853.051</td></tr> <tr><td style="text-align: center;">34857.115</td><td style="text-align: center;">12853.134</td></tr> <tr><td style="text-align: center;">34785.117</td><td style="text-align: center;">12853.255</td></tr> <tr><td style="text-align: center;">34711.351</td><td style="text-align: center;">12853.380</td></tr> <tr><td style="text-align: center;">34706.428</td><td style="text-align: center;">12853.384</td></tr> </tbody> </table> to the point of commencement.  The boundaries of “SOON LEE BUS DEPOT” are more particularly delineated in the Survey Plan No. LTA/PP/GAZ/SBST/SLBD filed in the office of the Deputy Director, Public Transport Security Division, Land Transport Authority of Singapore, a copy of which is set out below.	<i>Northing</i>	<i>Easting</i>	34706.340	12979.403	34809.108	12979.316	34909.107	12979.231	34918.251	12969.204	34918.257	12853.051	34857.115	12853.134	34785.117	12853.255	34711.351	12853.380	34706.428	12853.384
<i>Northing</i>	<i>Easting</i>																				
34706.340	12979.403																				
34809.108	12979.316																				
34909.107	12979.231																				
34918.251	12969.204																				
34918.257	12853.051																				
34857.115	12853.134																				
34785.117	12853.255																				
34711.351	12853.380																				
34706.428	12853.384																				

THE SCHEDULE — *continued*

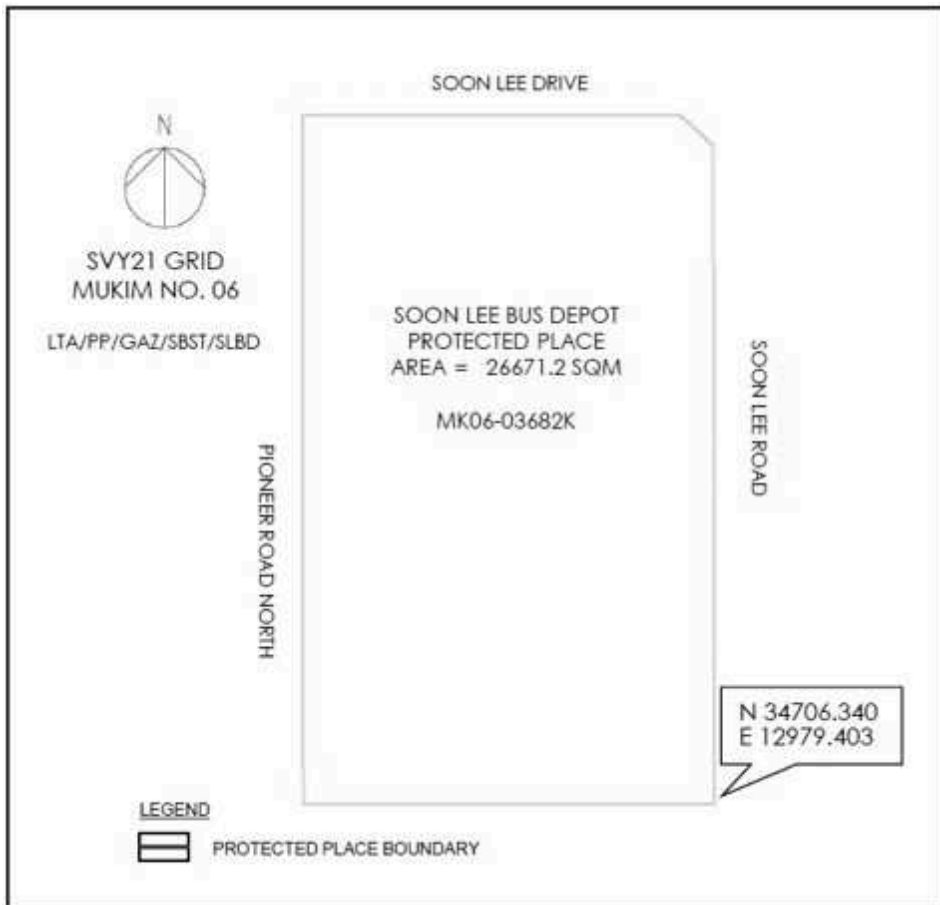

THE SCHEDULE — *continued*

<i>First column</i>	<i>Second column</i>																																
The Authority	Protected Place																																
Head, Bus Depot, SBS Transit Ltd	<p>(7) ULU PANDAN BUS DEPOT</p> <p>All that area comprised in part of State Land Lots 03417M, 05361K, 09074K, 09075N, 09078C, 05973X and 05978V in Mukim No. 05 occupied by “ULU PANDAN BUS DEPOT” containing an area of about 96340.1 square metres and bounded approximately as follows:</p> <p>Commencing at the westernmost corner of the perimeter fence and wall of the State Land Lot 05978V in Mukim No. 05 at a point 34243.8 metres North and 18818.6 metres East of the Singapore Land Authority SVY 21 Datum, the boundaries run along successive lines of coordinates approximately as follows:</p> <table border="0" style="margin-left: auto; margin-right: auto;"> <thead> <tr> <th style="text-align: left;"><i>Northing</i></th> <th style="text-align: left;"><i>Easting</i></th> </tr> </thead> <tbody> <tr><td>34243.8</td><td>18818.6</td></tr> <tr><td>34256.9</td><td>18841.4</td></tr> <tr><td>34269.8</td><td>18864.0</td></tr> <tr><td>34238.3</td><td>18881.0</td></tr> <tr><td>34206.0</td><td>18898.4</td></tr> <tr><td>34202.4</td><td>18900.3</td></tr> <tr><td>34201.8</td><td>18900.0</td></tr> <tr><td>34186.2</td><td>18909.1</td></tr> <tr><td>34179.9</td><td>18912.8</td></tr> <tr><td>34180.3</td><td>18913.5</td></tr> <tr><td>34181.1</td><td>18914.8</td></tr> <tr><td>34183.3</td><td>18913.6</td></tr> <tr><td>34193.7</td><td>18931.1</td></tr> <tr><td>34203.6</td><td>18947.7</td></tr> <tr><td>34201.4</td><td>18955.0</td></tr> </tbody> </table>	<i>Northing</i>	<i>Easting</i>	34243.8	18818.6	34256.9	18841.4	34269.8	18864.0	34238.3	18881.0	34206.0	18898.4	34202.4	18900.3	34201.8	18900.0	34186.2	18909.1	34179.9	18912.8	34180.3	18913.5	34181.1	18914.8	34183.3	18913.6	34193.7	18931.1	34203.6	18947.7	34201.4	18955.0
<i>Northing</i>	<i>Easting</i>																																
34243.8	18818.6																																
34256.9	18841.4																																
34269.8	18864.0																																
34238.3	18881.0																																
34206.0	18898.4																																
34202.4	18900.3																																
34201.8	18900.0																																
34186.2	18909.1																																
34179.9	18912.8																																
34180.3	18913.5																																
34181.1	18914.8																																
34183.3	18913.6																																
34193.7	18931.1																																
34203.6	18947.7																																
34201.4	18955.0																																

THE SCHEDULE — *continued*

<i>First column</i>	<i>Second column</i>
The Authority	Protected Place
34143.3	18989.5
34100.8	19014.7
34089.0	19021.7
34082.6	19025.1
34078.2	19027.1
34069.0	19030.2
34062.0	19031.8
34054.8	19032.9
34045.2	19033.4
34033.2	19032.4
34026.0	19031.6
34021.0	19030.6
34021.2	19029.5
34014.5	19027.2
34007.9	19024.3
34001.6	19020.8
33995.5	19017.0
33991.8	19014.0
33988.0	19010.7
33986.5	19012.5
33983.8	19016.4
33981.8	19020.8
33980.5	19025.4
33979.9	19030.2
33980.5	19034.9
33981.3	19037.1
33982.4	19039.2

THE SCHEDULE — *continued*

<i>First column</i>		<i>Second column</i>
The Authority		Protected Place
	33983.7	19041.3
	33985.3	19043.0
	33987.2	19044.4
	33991.4	19047.0
	33997.5	19050.6
	34004.5	19054.3
	34005.6	19054.0
	34006.6	19054.4
	34010.5	19056.0
	34020.0	19058.6
	34022.4	19059.2
	34029.5	19060.4
	34036.7	19061.3
	34046.4	19061.5
	34048.8	19061.4
	34056.1	19061.0
	34065.7	19059.6
	34072.7	19057.9
	34079.8	19055.9
	34084.3	19054.4
	34093.2	19050.6
	34096.9	19048.5
	34105.4	19043.8
	34113.8	19038.9
	34126.3	19031.5
	34159.9	19011.5
	34197.2	18989.4

THE SCHEDULE — *continued*

<i>First column</i>	<i>Second column</i>
The Authority	Protected Place
34198.8	18990.1
34199.9	18990.8
34201.3	18992.2
34202.7	18994.1
34203.5	18996.7
34203.7	18999.0
34203.4	19001.1
34202.7	19003.2
34202.0	19005.2
34226.1	19013.1
34227.5	19008.9
34227.0	19008.7
34231.4	18995.4
34239.4	18998.1
34245.2	18980.6
34252.5	18958.9
34254.2	18957.1
34259.0	18952.9
34267.3	18948.0
34268.4	18949.8
34272.5	18947.4
34271.3	18945.4
34273.4	18944.1
34274.8	18946.5
34280.3	18943.3
34278.9	18941.0
34287.4	18935.8

THE SCHEDULE — *continued*

<i>First column</i>		<i>Second column</i>
The Authority		Protected Place
	34293.5	18932.6
	34299.7	18930.0
	34306.2	18927.9
	34313.0	18926.3
	34319.5	18925.5
	34326.7	18925.2
	34334.0	18925.5
	34340.8	18926.5
	34348.6	18928.5
	34352.3	18929.7
	34355.8	18931.1
	34358.3	18932.2
	34364.6	18935.2
	34372.1	18938.8
	34381.0	18943.1
	34385.4	18945.5
	34386.9	18946.8
	34378.9	18971.3
	34369.5	18999.5
	34352.5	19050.4
	34339.4	19089.6
	34327.1	19126.4
	34315.5	19161.0
	34300.1	19207.1
	34302.2	19207.9
	34301.9	19209.0
	34298.8	19218.1

THE SCHEDULE — *continued*

<i>First column</i>		<i>Second column</i>
The Authority		Protected Place
	34293.0	19235.4
	34292.8	19235.8
	34291.5	19235.5
	34290.6	19238.3
	34264.7	19230.5
	34260.0	19229.2
	34256.0	19228.2
	34248.9	19226.6
	34244.3	19226.0
	34240.9	19225.7
	34234.1	19225.7
	34221.3	19228.0
	34216.6	19229.1
	34188.2	19238.7
	34156.3	19249.5
	34122.1	19261.2
	34107.1	19235.7
	34069.5	19171.3
	34045.1	19129.6
	34027.1	19098.8
	34023.3	19093.4
	34012.8	19082.3
	34005.9	19077.4
	34000.1	19074.4
	33994.2	19071.8
	33987.5	19068.7
	33983.3	19066.3

THE SCHEDULE — *continued*

<i>First column</i>		<i>Second column</i>
The Authority		Protected Place
	33979.3	19063.7
	33975.6	19061.1
	33971.9	19058.0
	33968.7	19054.4
	33965.3	19049.6
	33963.6	19046.0
	33961.9	19041.6
	33960.9	19036.7
	33960.2	19032.0
	33959.8	19027.2
	33960.0	19022.3
	33960.8	19018.4
	33962.8	19013.1
	33965.6	19009.1
	33968.8	19005.5
	33973.8	19000.2
	33976.6	18996.4
	33983.8	18986.6
	33993.8	18973.0
	33996.3	18968.9
	33999.6	18964.0
	34000.9	18961.9
	34006.4	18955.3
	34024.4	18939.7
	34026.6	18938.6
	34067.8	18917.3
	34102.4	18899.4

THE SCHEDULE — *continued*

<i>First column</i>	<i>Second column</i>
The Authority	Protected Place
34143.5	18875.9
34172.3	18859.5
34216.6	18834.1

to the point of commencement.

The boundaries of “ULU PANDAN BUS DEPOT” are more particularly delineated in the Survey Plan No. LTA/PP/GAZ/LTA/UPBD filed in the office of the Deputy Director, Public Transport Security Division, Land Transport Authority of Singapore, a copy of which is set out below.

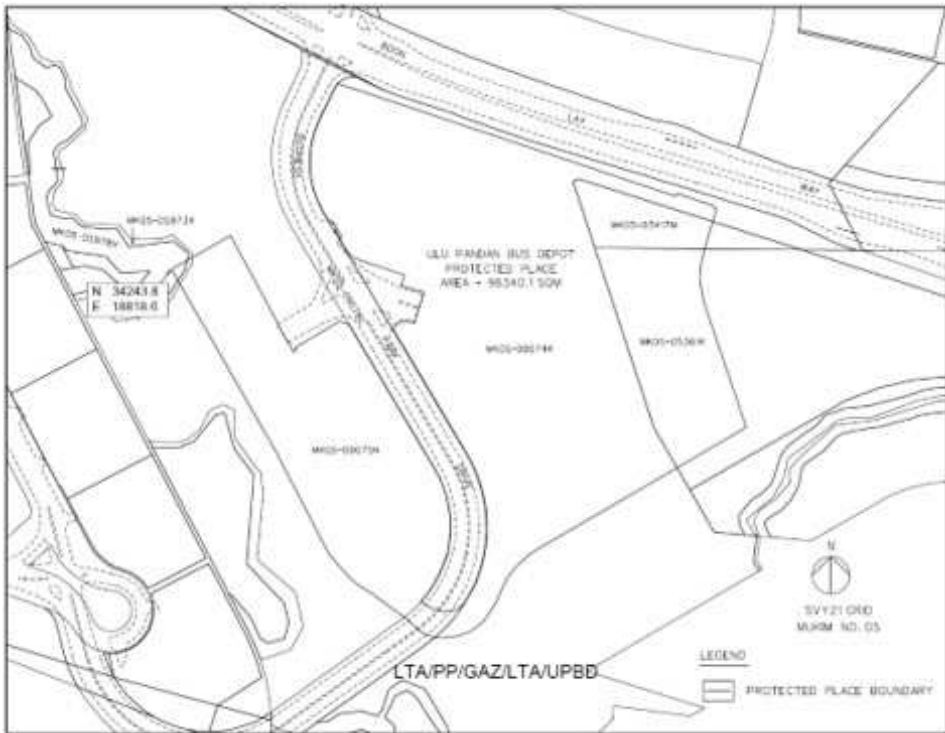

THE SCHEDULE — *continued*

<i>First column</i>	<i>Second column</i>																																		
The Authority	Protected Place																																		
2. Managing Director, Go-Ahead Singapore	<p>LOYANG BUS DEPOT</p> <p>All that area comprised in part of State Land Lots 05157A and 05154V in Mukim No. 31 occupied by “LOYANG BUS DEPOT” containing an area of about 82382.4 square metres and bounded approximately as follows:</p> <p>Commencing at the westernmost corner of the perimeter fence and wall of the State Land Lot 05157A in Mukim No. 31 at a point 38702.8 metres North and 42814.2 metres East of the Singapore Land Authority SVY 21 Datum, the boundaries run along successive lines of coordinates approximately as follows:</p> <table border="0" style="margin-left: auto; margin-right: auto;"> <thead> <tr> <th style="text-align: left;"><i>Northing</i></th> <th style="text-align: left;"><i>Easting</i></th> </tr> </thead> <tbody> <tr><td>38702.8</td><td>42814.2</td></tr> <tr><td>38704.7</td><td>42812.0</td></tr> <tr><td>38726.2</td><td>42791.4</td></tr> <tr><td>38739.6</td><td>42779.2</td></tr> <tr><td>38756.4</td><td>42765.9</td></tr> <tr><td>38773.8</td><td>42757.8</td></tr> <tr><td>38789.6</td><td>42747.3</td></tr> <tr><td>38806.2</td><td>42733.4</td></tr> <tr><td>38807.2</td><td>42732.5</td></tr> <tr><td>38810.8</td><td>42729.4</td></tr> <tr><td>38816.9</td><td>42725.5</td></tr> <tr><td>38826.6</td><td>42720.0</td></tr> <tr><td>38849.5</td><td>42706.5</td></tr> <tr><td>38861.9</td><td>42699.2</td></tr> <tr><td>38866.0</td><td>42699.4</td></tr> <tr><td>38870.8</td><td>42700.5</td></tr> </tbody> </table>	<i>Northing</i>	<i>Easting</i>	38702.8	42814.2	38704.7	42812.0	38726.2	42791.4	38739.6	42779.2	38756.4	42765.9	38773.8	42757.8	38789.6	42747.3	38806.2	42733.4	38807.2	42732.5	38810.8	42729.4	38816.9	42725.5	38826.6	42720.0	38849.5	42706.5	38861.9	42699.2	38866.0	42699.4	38870.8	42700.5
<i>Northing</i>	<i>Easting</i>																																		
38702.8	42814.2																																		
38704.7	42812.0																																		
38726.2	42791.4																																		
38739.6	42779.2																																		
38756.4	42765.9																																		
38773.8	42757.8																																		
38789.6	42747.3																																		
38806.2	42733.4																																		
38807.2	42732.5																																		
38810.8	42729.4																																		
38816.9	42725.5																																		
38826.6	42720.0																																		
38849.5	42706.5																																		
38861.9	42699.2																																		
38866.0	42699.4																																		
38870.8	42700.5																																		

THE SCHEDULE — *continued*

<i>First column</i>		<i>Second column</i>
The Authority		Protected Place
	38875.1	42702.5
	38879.0	42705.4
	38882.1	42709.0
	38889.9	42722.1
	38896.0	42732.8
	38897.9	42735.7
	38901.6	42740.7
	38914.1	42758.0
	38931.9	42788.7
	38945.5	42812.1
	38966.7	42848.5
	38976.3	42866.0
	38980.8	42873.7
	38981.6	42875.0
	38985.4	42881.7
	38995.5	42899.0
	39002.2	42910.2
	39010.1	42922.6
	39018.3	42934.7
	39026.7	42946.2
	39034.1	42956.0
	39043.3	42967.1
	39055.8	42981.5
	39072.6	42999.1
	39084.5	43010.6
	39115.2	43041.9
	39128.5	43054.2

THE SCHEDULE — *continued*

<i>First column</i>	<i>Second column</i>	
The Authority	Protected Place	
	39101.4	43079.9
	39035.8	43141.9
	39022.5	43154.3
	39002.1	43133.8
	38983.3	43115.4
	38962.5	43095.6
	38923.6	43060.0
	38886.2	43026.1
	38861.4	43003.5
	38817.0	42963.1
	38792.1	42940.5
	38765.6	42916.1
	38731.4	42879.2
	38703.5	42849.3
	38702.6	42847.3

to the point of commencement.

The boundaries of “LOYANG BUS DEPOT” are more particularly delineated in the Survey Plan No. LTA/PP/GAZ/LTA/LYBD filed in the office of the Deputy Director, Public Transport Security Division, Land Transport Authority of Singapore, a copy of which is set out below.

THE SCHEDULE — *continued*

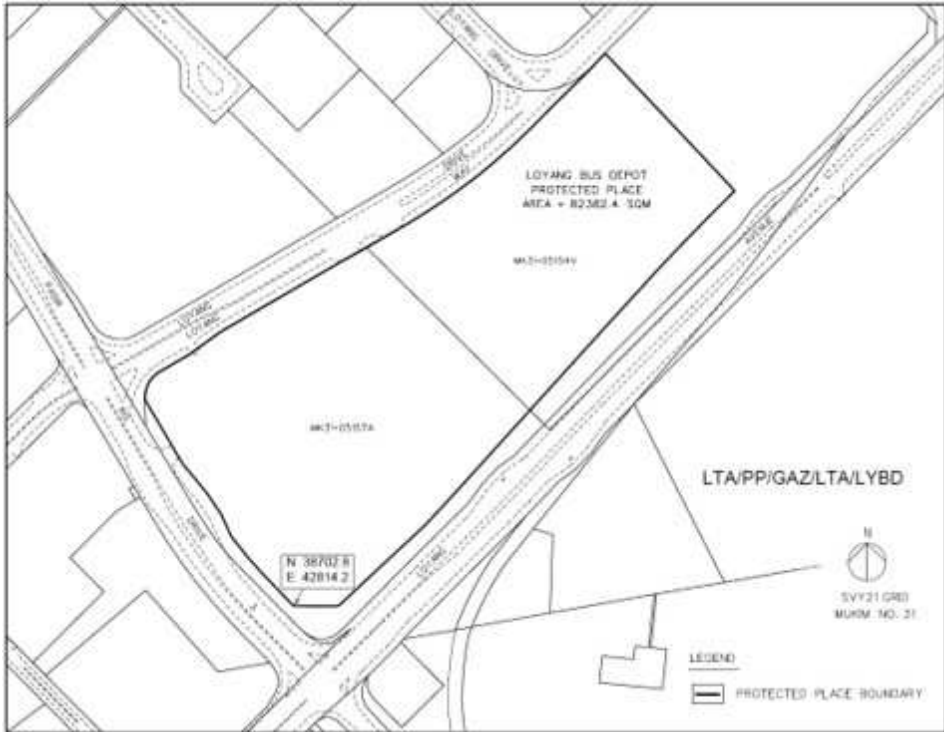

THE SCHEDULE — *continued*

<i>First column</i>	<i>Second column</i>																																
The Authority	Protected Place																																
3. Managing Director, Tower Transit Singapore	<p>(1) BULIM BUS DEPOT</p> <p>All that area comprised in part of State Land Lots 02035X, 02001A, 01498C, 01478N, 01379M and 01377L in Mukim No. 09 occupied by “BULIM BUS DEPOT” containing an area of about 98282.2 square metres and bounded approximately as follows:</p> <p>Commencing at the westernmost corner of the perimeter fence and wall of the State Land Lot 01498C in Mukim No. 09 at a point 38121.2 metres North and 13602.1 metres East of the Singapore Land Authority SVY 21 Datum, the boundaries run along successive lines of coordinates approximately as follows:</p> <table border="0" style="margin-left: auto; margin-right: auto;"> <thead> <tr> <th style="text-align: left;"><i>Northing</i></th> <th style="text-align: left;"><i>Easting</i></th> </tr> </thead> <tbody> <tr><td>38121.2</td><td>13602.1</td></tr> <tr><td>38188.5</td><td>13678.9</td></tr> <tr><td>38191.7</td><td>13682.6</td></tr> <tr><td>38199.5</td><td>13691.8</td></tr> <tr><td>38210.0</td><td>13705.1</td></tr> <tr><td>38219.9</td><td>13719.0</td></tr> <tr><td>38230.4</td><td>13735.3</td></tr> <tr><td>38241.1</td><td>13754.4</td></tr> <tr><td>38248.5</td><td>13769.7</td></tr> <tr><td>38253.6</td><td>13780.9</td></tr> <tr><td>38257.1</td><td>13789.9</td></tr> <tr><td>38261.2</td><td>13801.3</td></tr> <tr><td>38265.1</td><td>13815.4</td></tr> <tr><td>38268.2</td><td>13829.5</td></tr> <tr><td>38269.9</td><td>13839.2</td></tr> </tbody> </table>	<i>Northing</i>	<i>Easting</i>	38121.2	13602.1	38188.5	13678.9	38191.7	13682.6	38199.5	13691.8	38210.0	13705.1	38219.9	13719.0	38230.4	13735.3	38241.1	13754.4	38248.5	13769.7	38253.6	13780.9	38257.1	13789.9	38261.2	13801.3	38265.1	13815.4	38268.2	13829.5	38269.9	13839.2
<i>Northing</i>	<i>Easting</i>																																
38121.2	13602.1																																
38188.5	13678.9																																
38191.7	13682.6																																
38199.5	13691.8																																
38210.0	13705.1																																
38219.9	13719.0																																
38230.4	13735.3																																
38241.1	13754.4																																
38248.5	13769.7																																
38253.6	13780.9																																
38257.1	13789.9																																
38261.2	13801.3																																
38265.1	13815.4																																
38268.2	13829.5																																
38269.9	13839.2																																

THE SCHEDULE — *continued*

<i>First column</i>		<i>Second column</i>
The Authority		Protected Place
	38273.7	13874.0
	38274.4	13888.9
	38273.8	13925.1
	38272.2	13943.5
	38270.3	13963.0
	38268.6	13980.7
	38266.4	14002.4
	38264.7	14014.4
	38261.9	14028.8
	38258.1	14045.0
	38254.2	14056.4
	38250.5	14065.9
	38244.5	14079.4
	38236.4	14094.6
	38228.2	14109.3
	38222.9	14118.5
	38217.7	14127.7
	38214.1	14133.9
	38206.6	14124.7
	38191.4	14105.9
	38173.7	14083.9
	38162.4	14070.1
	38161.5	14068.9
	38152.2	14057.6
	38141.0	14043.9
	38134.2	14035.5
	38128.0	14027.9

THE SCHEDULE — *continued*

<i>First column</i>	<i>Second column</i>
The Authority	Protected Place
38116.7	14013.8
38115.3	14012.1
38114.5	14011.1
38105.4	14000.0
38097.0	13989.8
38093.0	13984.9
38079.8	13968.7
38076.5	13964.7
38067.4	13953.6
38012.2	13886.0
38004.6	13876.6
38008.8	13873.1
37973.3	13829.7
37937.1	13785.4
37927.4	13773.6
37924.7	13770.2
37954.1	13744.7
37990.6	13713.2
38033.8	13676.0
38034.5	13676.8
38080.5	13637.0

to the point of commencement.

The boundaries of “BULIM BUS DEPOT” are more particularly delineated in the Survey Plan No. LTA/PP/GAZ/LTA/BLBD filed in the office of the Deputy Director, Public Transport Security Division, Land Transport Authority of Singapore, a copy of which is set out below.



THE SCHEDULE — *continued*

<i>First column</i>	<i>Second column</i>																																
The Authority	Protected Place																																
Managing Director, Tower Transit Singapore	<p>(2) MANDAI BUS DEPOT</p> <p>All that area comprised in part of State Land Lots 04119C, 05669K and 05668A in Mukim No. 13 occupied by “MANDAI BUS DEPOT” containing an area of about 110404.0 square metres and bounded approximately as follows:</p> <p>Commencing at the westernmost corner of the perimeter fence and wall of the Land Lot in part of State Land Lots 04119C, 05669K and 05668A in Mukim No. 13 at a point 44392.1 metres North and 23981.7 metres East of the Singapore Land Authority SVY 21 Datum, the boundaries run along successive lines of coordinates approximately as follows:</p> <table border="0" style="margin-left: auto; margin-right: auto;"> <thead> <tr> <th style="text-align: center;"><i>Northing</i></th> <th style="text-align: center;"><i>Easting</i></th> </tr> </thead> <tbody> <tr><td style="text-align: center;">44392.1</td><td style="text-align: center;">23981.7</td></tr> <tr><td style="text-align: center;">44404.0</td><td style="text-align: center;">23984.9</td></tr> <tr><td style="text-align: center;">44415.6</td><td style="text-align: center;">23988.5</td></tr> <tr><td style="text-align: center;">44427.2</td><td style="text-align: center;">23992.7</td></tr> <tr><td style="text-align: center;">44438.5</td><td style="text-align: center;">23997.3</td></tr> <tr><td style="text-align: center;">44449.6</td><td style="text-align: center;">24002.4</td></tr> <tr><td style="text-align: center;">44460.5</td><td style="text-align: center;">24007.9</td></tr> <tr><td style="text-align: center;">44471.2</td><td style="text-align: center;">24013.9</td></tr> <tr><td style="text-align: center;">44481.6</td><td style="text-align: center;">24020.3</td></tr> <tr><td style="text-align: center;">44491.8</td><td style="text-align: center;">24027.2</td></tr> <tr><td style="text-align: center;">44501.6</td><td style="text-align: center;">24034.4</td></tr> <tr><td style="text-align: center;">44511.2</td><td style="text-align: center;">24042.1</td></tr> <tr><td style="text-align: center;">44520.4</td><td style="text-align: center;">24050.1</td></tr> <tr><td style="text-align: center;">44529.3</td><td style="text-align: center;">24058.6</td></tr> <tr><td style="text-align: center;">44537.8</td><td style="text-align: center;">24067.4</td></tr> </tbody> </table>	<i>Northing</i>	<i>Easting</i>	44392.1	23981.7	44404.0	23984.9	44415.6	23988.5	44427.2	23992.7	44438.5	23997.3	44449.6	24002.4	44460.5	24007.9	44471.2	24013.9	44481.6	24020.3	44491.8	24027.2	44501.6	24034.4	44511.2	24042.1	44520.4	24050.1	44529.3	24058.6	44537.8	24067.4
<i>Northing</i>	<i>Easting</i>																																
44392.1	23981.7																																
44404.0	23984.9																																
44415.6	23988.5																																
44427.2	23992.7																																
44438.5	23997.3																																
44449.6	24002.4																																
44460.5	24007.9																																
44471.2	24013.9																																
44481.6	24020.3																																
44491.8	24027.2																																
44501.6	24034.4																																
44511.2	24042.1																																
44520.4	24050.1																																
44529.3	24058.6																																
44537.8	24067.4																																

THE SCHEDULE — *continued*

<i>First column</i>	<i>Second column</i>
The Authority	Protected Place
44545.9	24076.5
44553.7	24085.9
44561.1	24095.7
44568.0	24105.8
44574.5	24116.1
44580.6	24126.7
44581.4	24128.7
44581.5	24130.7
44581.0	24132.7
44580.0	24134.5
44467.0	24280.5
44467.6	24306.7
44470.6	24305.9
44471.0	24325.5
44470.9	24330.8
44470.5	24336.0
44469.7	24341.2
44468.5	24346.3
44467.0	24351.3
44465.1	24356.2
44462.9	24361.0
44460.3	24365.5
44472.0	24374.5
44472.3	24374.7
44462.7	24386.3
44449.1	24402.2
44441.7	24410.5

THE SCHEDULE — *continued*

<i>First column</i>		<i>Second column</i>
The Authority		Protected Place
	44431.4	24421.6
	44416.9	24436.8
	44392.2	24462.9
	44385.4	24470.1
	44381.8	24470.3
	44372.8	24469.4
	44364.1	24466.9
	44355.9	24462.9
	44322.0	24442.6
	44235.1	24393.0
	44228.4	24388.2
	44222.6	24382.2
	44218.1	24376.3
	44214.3	24369.3
	44211.8	24363.0
	44194.9	24298.4
	44190.6	24277.9
	44199.2	24263.1
	44202.3	24257.7
	44202.4	24257.8
	44213.8	24237.9
	44217.9	24230.4
	44224.7	24218.1
	44257.0	24161.6
	44257.0	24161.4
	44256.9	24161.5
	44258.2	24140.3

THE SCHEDULE — *continued*

<i>First column</i>	<i>Second column</i>	
The Authority	Protected Place	
	44260.4	24141.6
	44267.4	24142.1
	44267.9	24135.1
	44384.8	23984.2
	44386.3	23982.8
	44388.1	23981.9
	44390.1	23981.5

to the point of commencement.

The boundaries of “MANDAI BUS DEPOT” are more particularly delineated in the Survey Plan No. LTA/PP/GAZ/TEL(BUS) filed in the office of the Deputy Director, Public Transport Security Division, Land Transport Authority of Singapore, a copy of which is set out below.

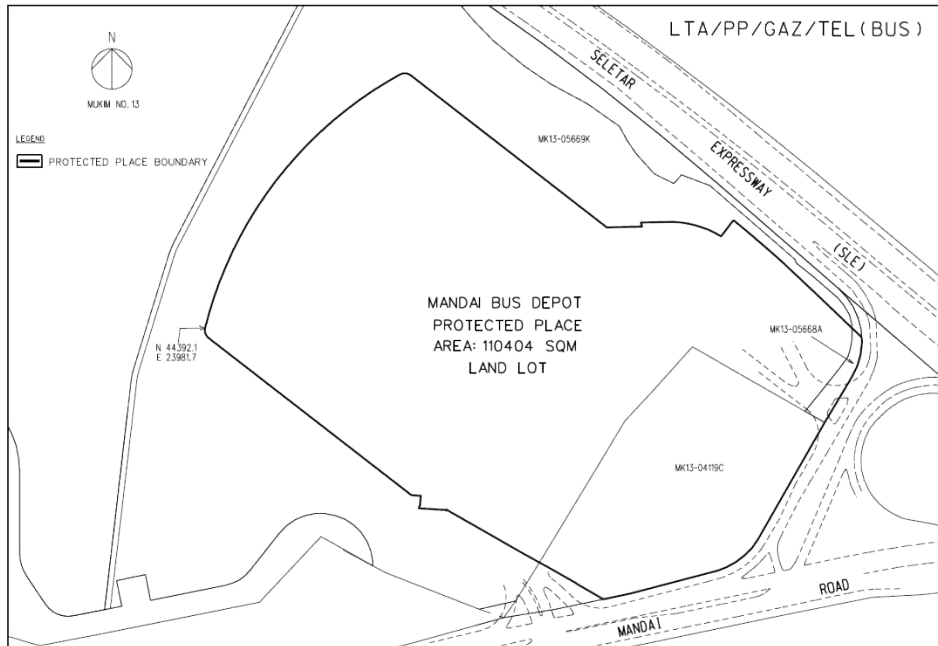

THE SCHEDULE — *continued**[S 794/2025 wef 15/12/2025]*

<i>First column</i>	<i>Second column</i>
The Authority	Protected Place
4. President, Roads, SMRT Buses Ltd	(1) [ <i>Deleted by S 794/2025 wef 15/12/2025</i> ]

<i>First column</i>	<i>Second column</i>
The Authority	Protected Place
President, Roads, SMRT Buses Ltd	(2) WOODLANDS BUS DEPOT

All that area comprised in Land Lot 03419P in Mukim No. 13 occupied by “WOODLANDS BUS DEPOT” containing an area of about 25760.4 square metres and bounded approximately as follows:

Commencing at the westernmost corner of the perimeter fence and wall of the Land Lot 03419P in Mukim No. 13 at a point 47954.387 metres North and 23801.634 metres East of the Singapore Land Authority SVY 21 Datum, the boundaries run along successive lines of coordinates approximately as follows:

<i>Northing</i>	<i>Easting</i>
47954.387	23801.634
47765.806	23672.908
47793.551	23753.258
47802.976	23779.330
47813.143	23805.121
47820.755	23823.130
47832.866	23849.874
47834.209	23851.846
47836.097	23853.304
47838.345	23854.105

THE SCHEDULE — *continued*

<i>First column</i>	<i>Second column</i>
The Authority	Protected Place
47840.730	23854.169
47843.018	23853.491
47912.610	23820.223
47915.349	23819.431
47918.197	23819.567
47920.848	23820.617
47923.017	23822.467
47930.401	23818.224
47937.846	23813.447
47894.584	23628.441

to the point of commencement.

The boundaries of “WOODLANDS BUS DEPOT” are more particularly delineated in the Survey Plan No. LTA/PP/GAZ/SMRT/WLBD filed in the office of the Deputy Director, Public Transport Security Division, Land Transport Authority of Singapore, a copy of which is set out below.

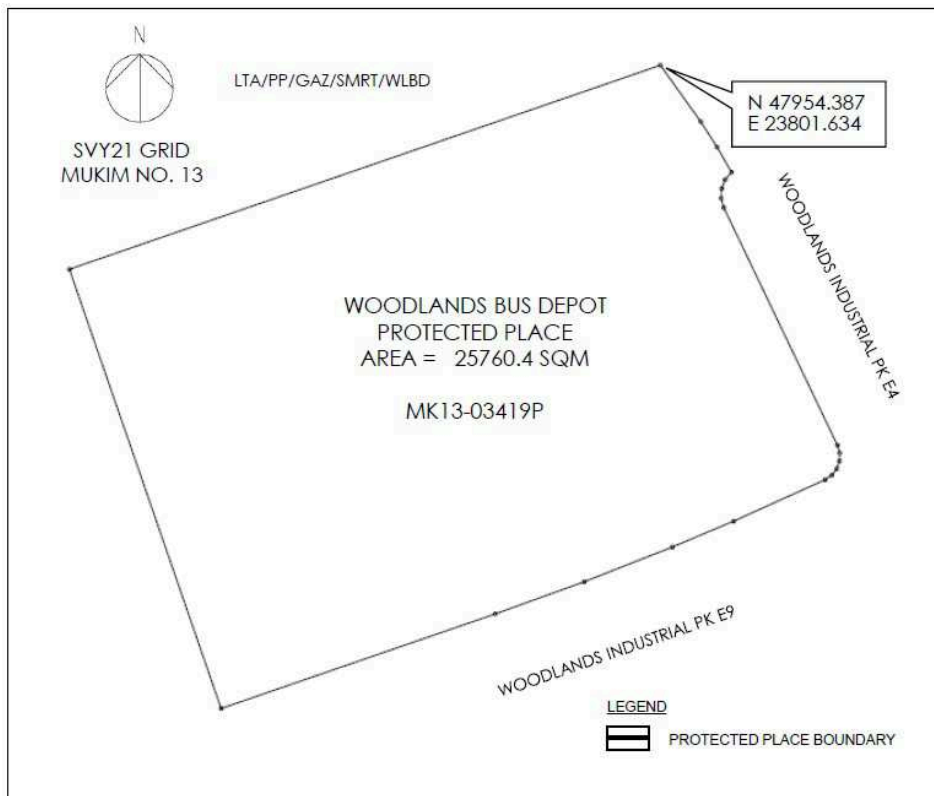
THE SCHEDULE — *continued*

Made on 1 December 2020.

PANG KIN KEONG  
*Permanent Secretary,  
Ministry of Home Affairs,  
Singapore.*

[SPF/CPS/C/09/10/04; AG/LEGIS/SL/137B/2020/2 Vol. 1]