



27 September 2017  
27 September 2017  
P.U. (A) 271

WARTA KERAJAAN PERSEKUTUAN

*FEDERAL GOVERNMENT  
GAZETTE*

PERINTAH HAD LAJU (LEBUH RAYA DUTA-ULU KELANG  
FASA 2 TUN RAZAK LINK) 2017

*SPEED LIMIT (DUTA-ULU KELANG EXPRESSWAY PHASE 2  
TUN RAZAK LINK) ORDER 2017*

DISIARKAN OLEH/  
PUBLISHED BY  
JABATAN PEGUAM NEGARA/  
ATTORNEY GENERAL'S CHAMBERS

AKTA PENGANGKUTAN JALAN 1987

PERINTAH HAD LAJU (LEBUH RAYA DUTA-ULU KELANG FASA 2  
TUN RAZAK LINK) 2017

PADA menjalankan kuasa yang diberikan oleh subseksyen 69(2) Akta Pengangkutan Jalan 1987 [*Akta 333*], Menteri membuat perintah yang berikut:

**Nama dan permulaan kuat kuasa**

1. (1) Perintah ini bolehlah dinamakan **Perintah Had Laju (Lebuh Raya Duta-Ulu Kelang Fasa 2 Tun Razak Link) 2017**.

(2) Perintah ini mula berkuat kuasa pada 28 September 2017.

**Larangan**

2. (1) Pemanduan suatu kenderaan motor dengan kelajuan yang melebihi had laju yang dinyatakan dalam ruang (2) Jadual Pertama di atas jalan yang dinyatakan dalam ruang (1) Jadual Pertama dilarang.

(2) Jalan dengan had laju yang dinyatakan di bawah subperenggan (1) ditunjukkan dalam peta dalam Jadual Kedua.

## JADUAL PERTAMA

(1)	(2)
<i>Jalan</i>	<i>Had Laju (km/j)</i>
Bahagian jalan yang dikenali sebagai Lebuhraya Duta-Ulu Kelang Fasa 2 Tun Razak Link yang bermula dari—	
(a) Laluan Utama di kilometer 0.00 di koordinat U 550.551, T -226.534 Grid Cassini Negeri Selangor dan berakhir di kilometer 1.27 di koordinat U 1599.084, T -534.147 Grid Cassini Negeri Selangor;	50
(b) Tanjakan Masuk dari Jalan Tun Razak di—	
(i) koordinat U 0.884, T -541.434 Grid Cassini Negeri Selangor dan berakhir di koordinat U 154.310, T -289.789 Grid Cassini Negeri Selangor; dan	40
(ii) koordinat U -109.045, T 118.474 Grid Cassini Negeri Selangor dan berakhir di koordinat U 154.310, T -289.789 Grid Cassini Negeri Selangor;	40
(c) Tanjakan Keluar ke Jalan Pahang di koordinat U 508.353, T -237.344 Grid Cassini Negeri Selangor dan berakhir di koordinat U 267.193, T -276.195 Grid Cassini Negeri Selangor;	40
(d) Tanjakan Keluar ke Jalan 9/48A di koordinat U 1763.187, T -552.045 Grid Cassini Negeri Selangor dan berakhir di koordinat U 1509.234, T -356.671 Grid Cassini Negeri Selangor;	40

- (e) Pusingan U Bertingkat berhampiran Jalan Sentul di—
- (i) koordinat U 1806.464, T -675.600 Grid Cassini Negeri Selangor dan berakhir di koordinat U 1865.075, T -523.663 Grid Cassini Negeri Selangor; 30
  - (ii) koordinat U 1865.075, T -523.663 Grid Cassini Negeri Selangor dan berakhir di koordinat U 2150.115, T -361.166 Grid Cassini Negeri Selangor; dan 50
  - (iii) koordinat U 1637.002, T -581.394 Grid Cassini Negeri Selangor dan berakhir di koordinat U 1888.967, T -930.961 Grid Cassini Negeri Selangor; 40
- (f) Pusingan U Bertingkat berhampiran Bandar Dalam di—
- (i) koordinat U 2150.115, T -361.166 Grid Cassini Negeri Selangor dan berakhir di koordinat U 2607.444, T -388.858 Grid Cassini Negeri Selangor; dan 50
  - (ii) koordinat U 2607.444, T -388.858 Grid Cassini Negeri Selangor dan berakhir di koordinat U 2631.744, T -346.635 Grid Cassini Negeri Selangor; 30
- (g) Plaza Tol Sentul Pasar Tambahan di koordinat U 2631.744, T -346.635 Grid Cassini Negeri Selangor dan berakhir di koordinat U 2144.766, T -320.904 Grid Cassini Negeri Selangor; 40
- (h) Tanjakan Masuk dan Keluar di Taman Sri Setapak di—
- (i) koordinat U 2144.766, T -320.904 Grid Cassini Negeri Selangor dan berakhir di koordinat U 1993.363, T 29.656 Grid Cassini Negeri Selangor; 40

(ii) koordinat U 1993.363, T 29.656 Grid Cassini Negeri Selangor dan berakhir di koordinat U 1750.652, T -368.271 Grid Cassini Negeri Selangor; dan 40

(iii) koordinat U 2146.053, T -331.325 Grid Cassini Negeri Selangor dan berakhir di koordinat U 1599.084, T -534.147 Grid Cassini Negeri Selangor; dan 50

(i) Persimpangan Bertingkat Jalan Gombak di—

(i) koordinat U 1993.363, T 29.656 Grid Cassini Negeri Selangor dan berakhir di koordinat U 2056.757, T 349.226 Grid Cassini Negeri Selangor; dan 40

(ii) koordinat U 2179.605, T 343.332 Grid Cassini Negeri Selangor dan berakhir di koordinat U 1993.363, T 29.656 Grid Cassini Negeri Selangor. 40

JADUAL KEDUA

PETA 1: LALUAN UTAMA

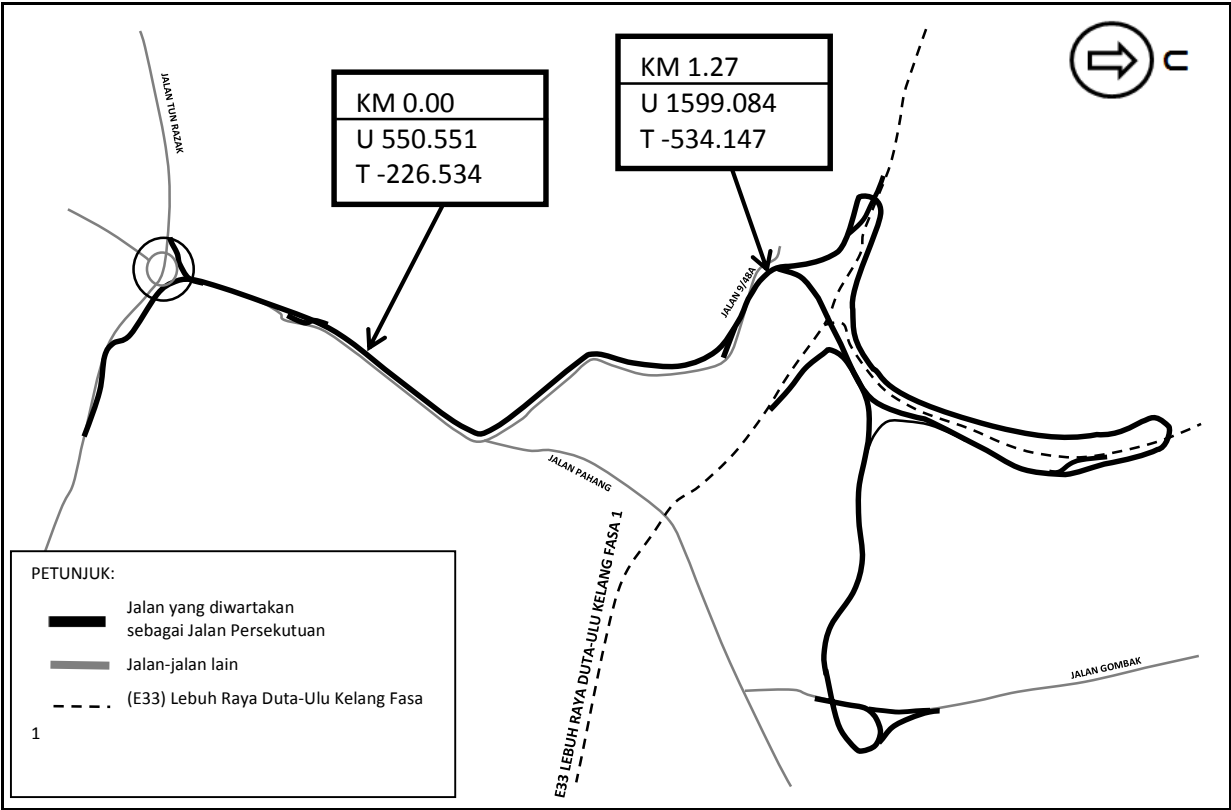

PETA 2: TANJAKAN MASUK DARI JALAN TUN RAZAK

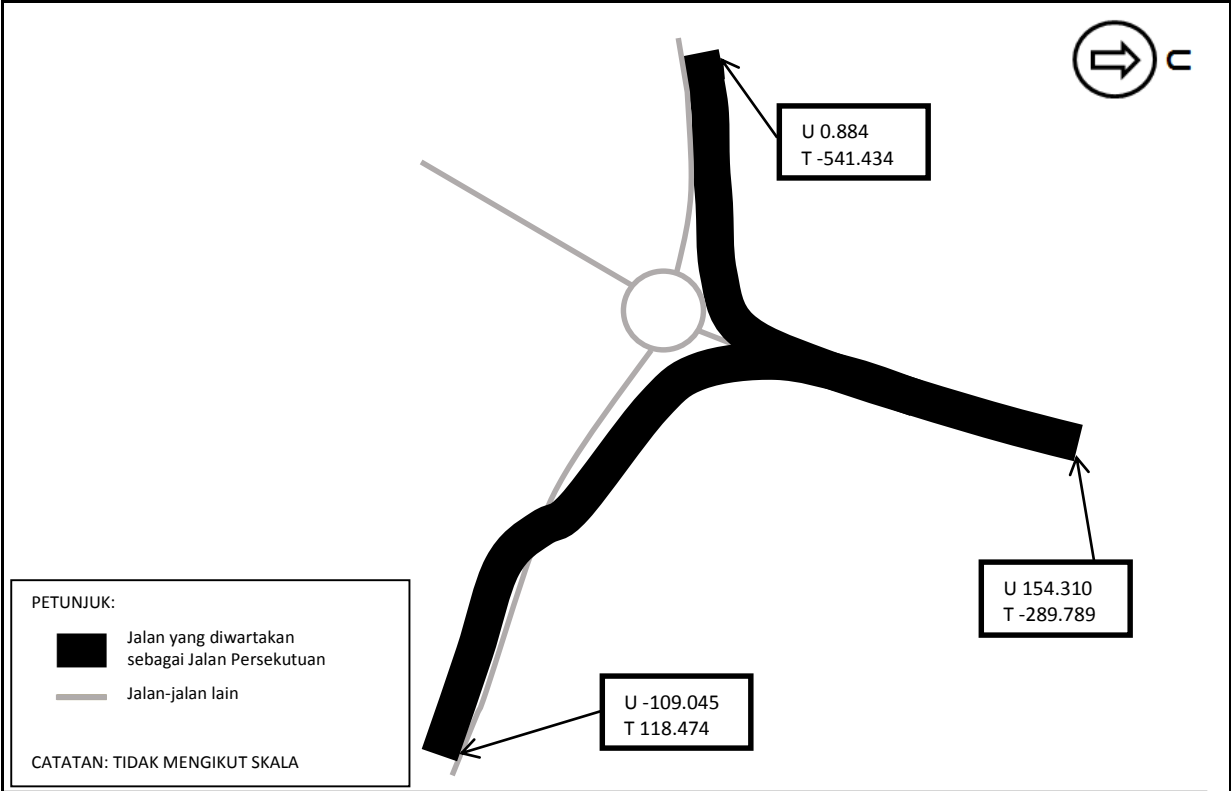

PETA 3: TANJAKAN KELUAR KE JALAN PAHANG

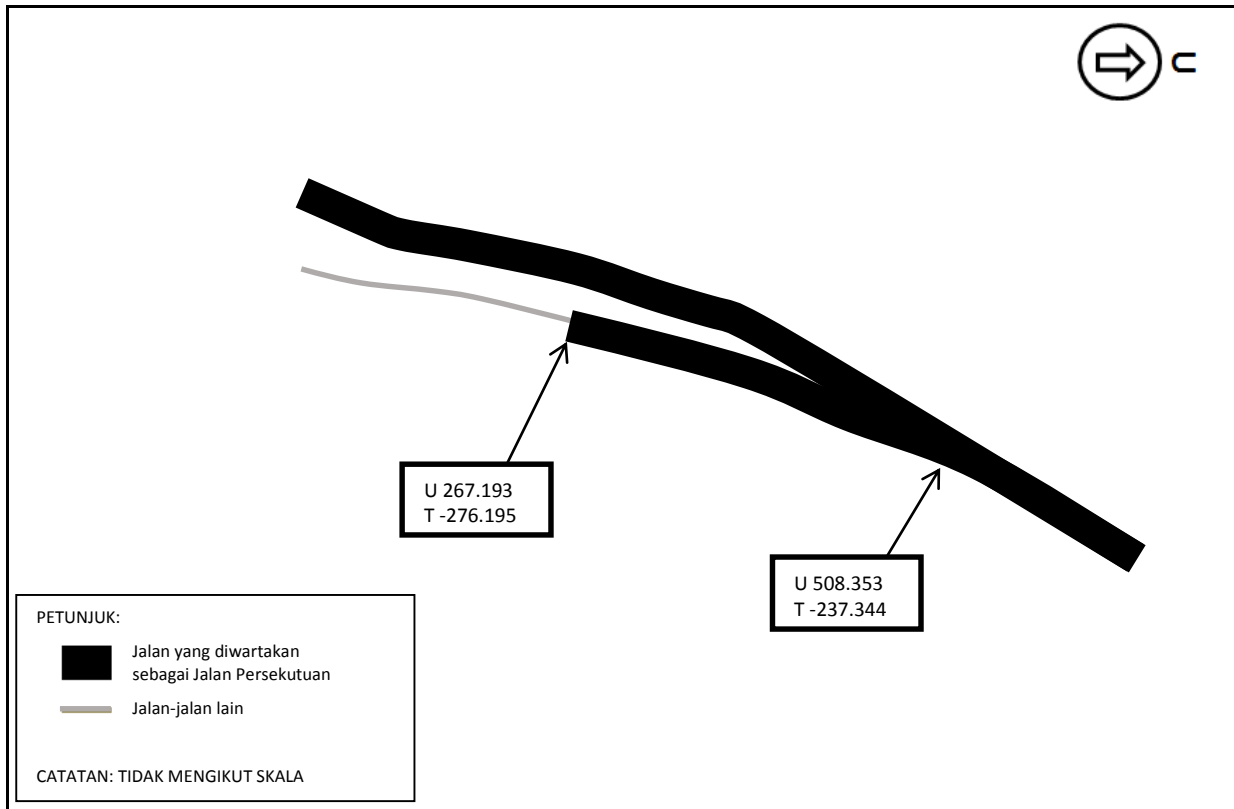

PETA 4: TANJAKAN KELUAR KE JALAN 9/48A

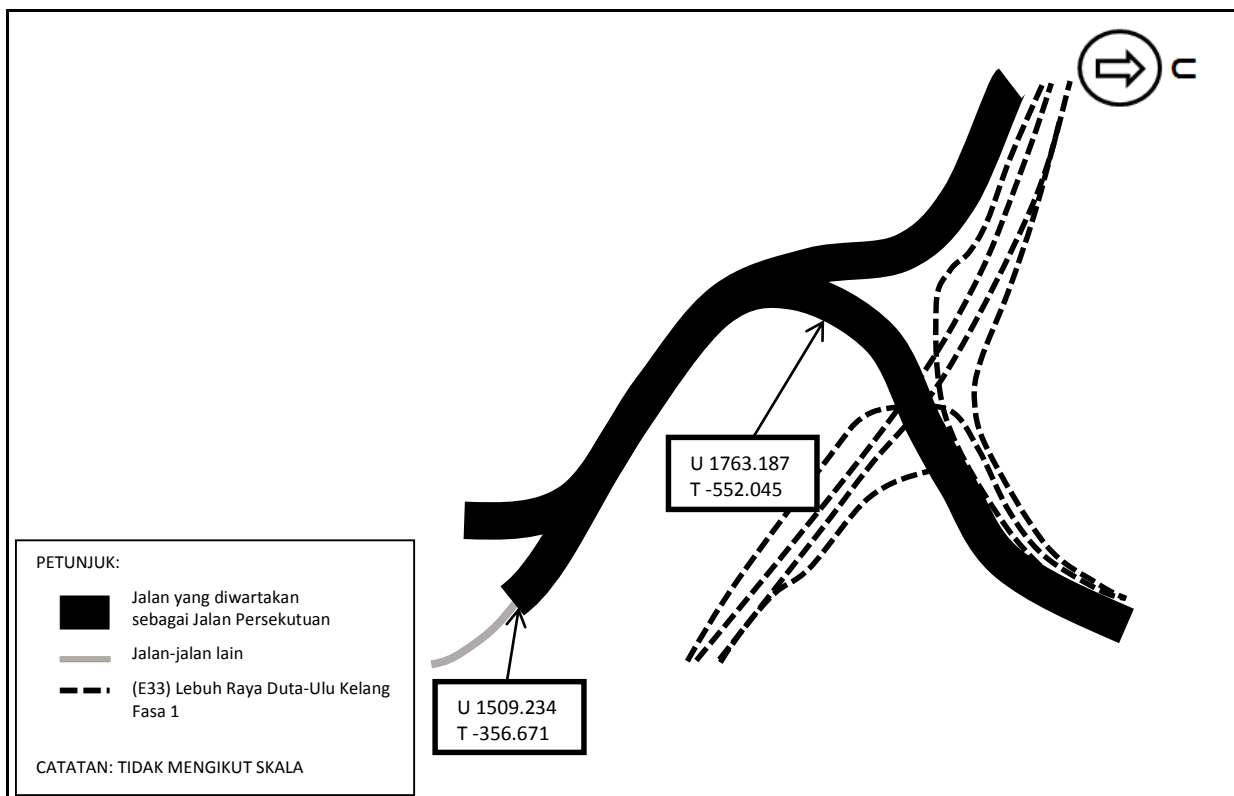

PETA 5: PUSINGAN U BERTINGKAT BERHAMPIRAN JALAN SENTUL

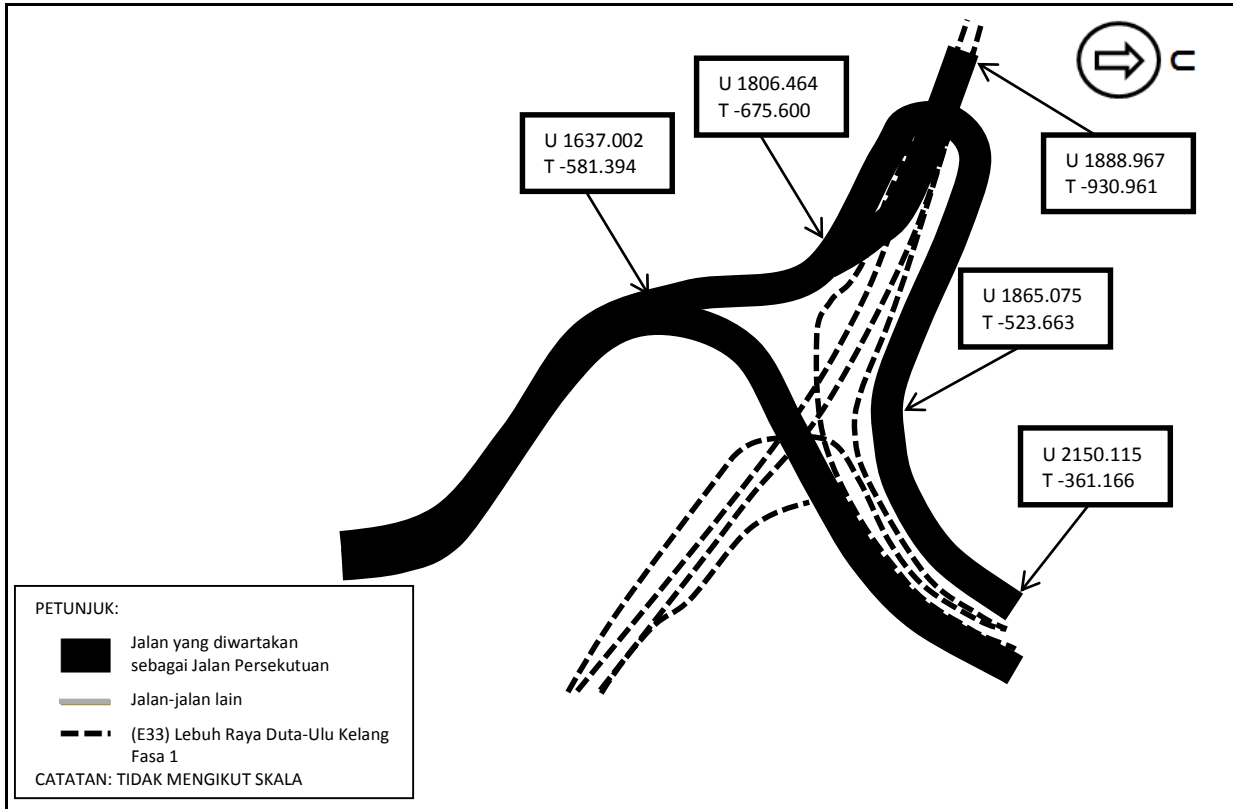

PETA 6: PUSINGAN U BERTINGKAT BERHAMPIRAN BANDAR DALAM

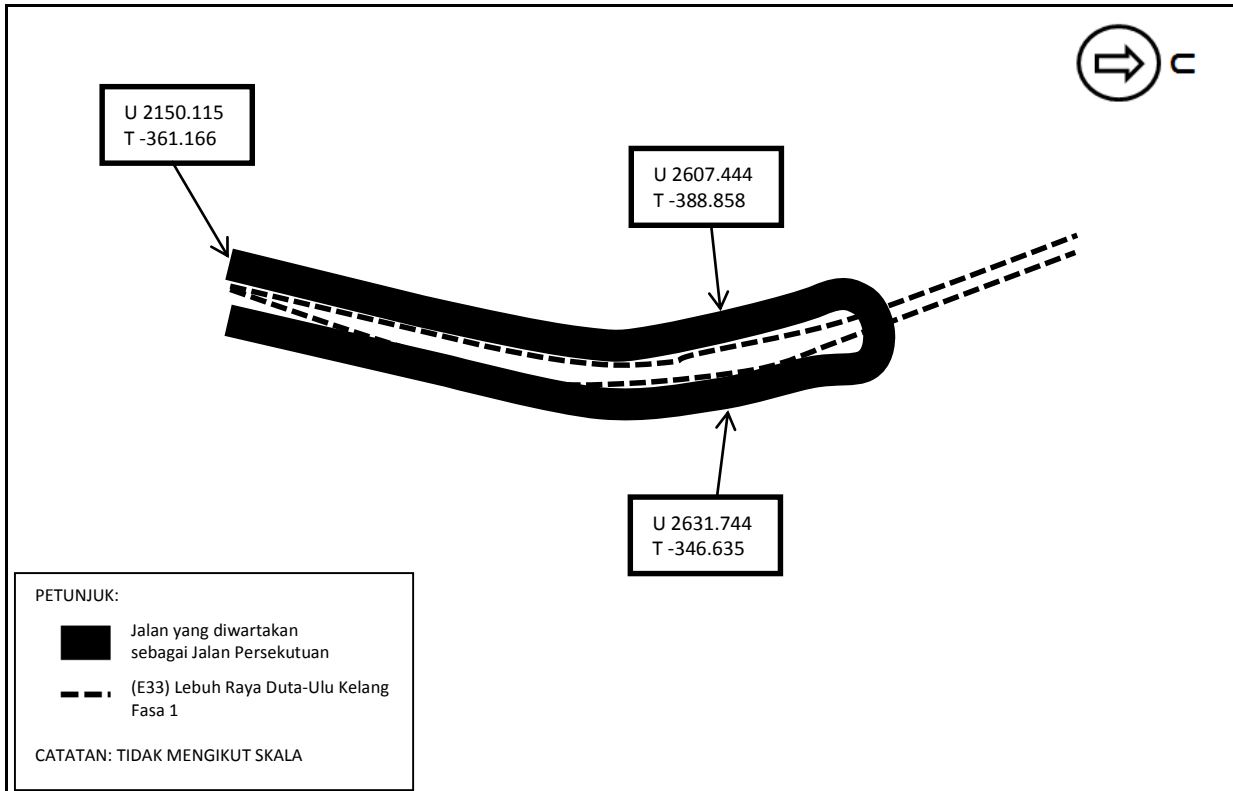

PETA 7: PLAZA TOL SENTUL PASAR TAMBAHAN

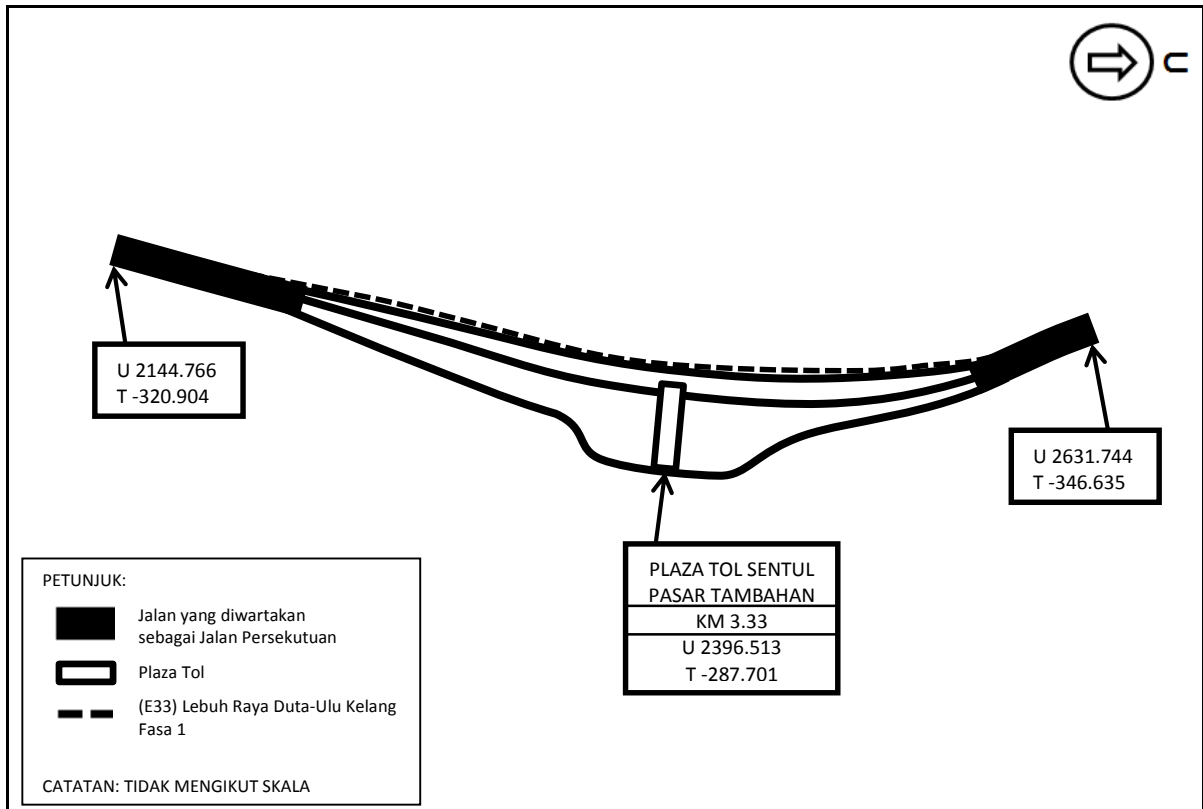

PETA 8: TANJAKAN MASUK DAN KELUAR DI TAMAN SRI SETAPAK

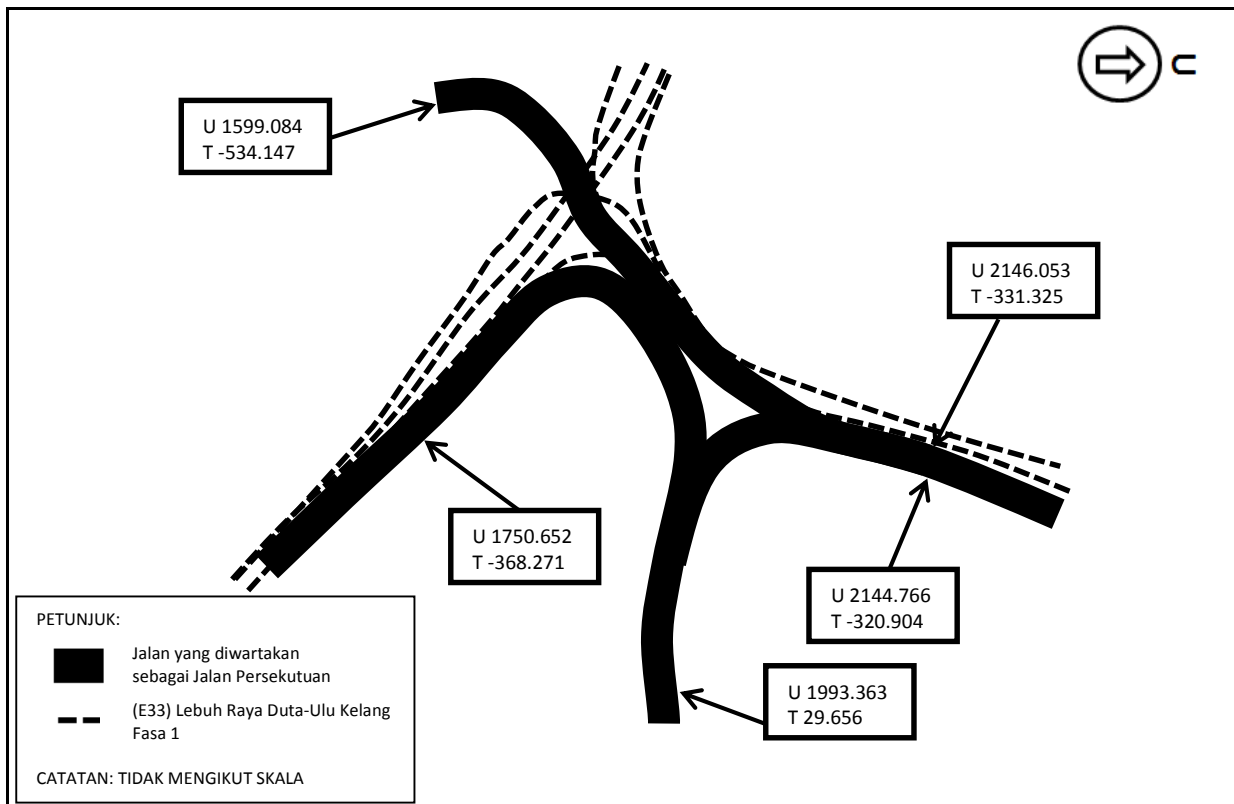

PETA 9: PERSIMPANGAN BERTINGKAT JALAN GOMBAK

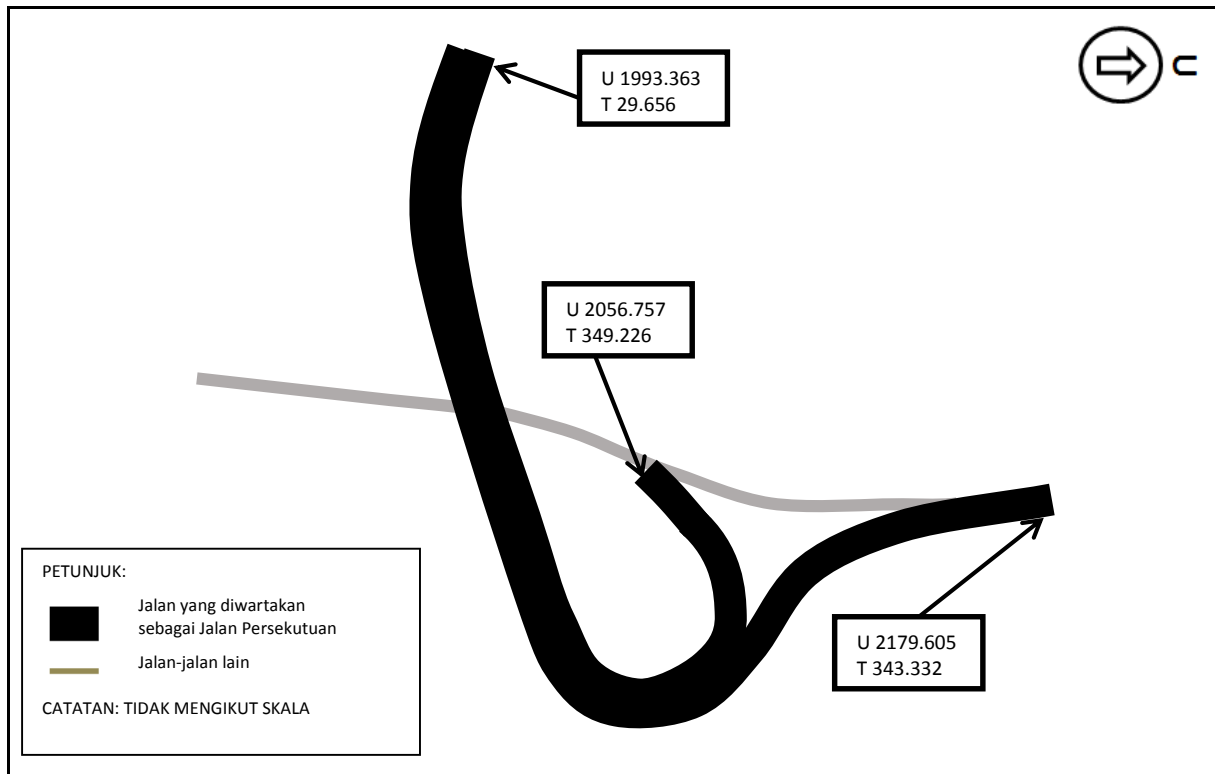

Dibuat 27 September 2017  
[KKR.PUU.110-1/7/32; PN(PU2)391/XXXIV]

DATO' SRI HAJI FADILLAH BIN HAJI YUSOF  
*Menteri Kerja Raya*

ROAD TRANSPORT ACT 1987

SPEED LIMIT (DUTA-ULU KELANG EXPRESSWAY PHASE 2 TUN RAZAK LINK)  
ORDER 2017

IN exercise of the powers conferred by subsection 69(2) of the Road Transport Act 1987 [Act 333], the Minister makes the following order:

**Citation and commencement**

1. (1) This order may be cited as the **Speed Limit (Duta-Ulu Kelang Expressway Phase 2 Tun Razak Link) Order 2017**.

(2) This Order comes into operation on 28 September 2017.

**Prohibition**

2. (1) The driving of a motor vehicle at a speed exceeding the speed limit specified in column (2) of the First Schedule on the road specified in column (1) of the First Schedule is prohibited.

(2) The road with speed limit as specified under subparagraph (1) is shown on the map in the Second Schedule.

## FIRST SCHEDULE

(1) <i>Road</i>	(2) <i>Speed Limit (km/h)</i>
That part of the road known as the Duta-Ulu Kelang Expressway Phase 2 Tun Razak Link commencing from—	
(a) the Main Route at kilometre 0.00 at coordinates N 550.551, E -226.534 of the Selangor State Cassini Grid and ending at kilometre 1.27 at coordinates N 1599.084, E -534.147 of the Selangor State Cassini Grid;	50
(b) On Ramp from Tun Razak Road at—	
(i) coordinates N 0.884, E -541.434 of the Selangor State Cassini Grid and ending at coordinates N 154.310, E -289.789 of the Selangor State Cassini Grid; and	40
(ii) coordinates N -109.045, E 118.474 of the Selangor State Cassini Grid and ending at coordinates N 154.310, E -289.789 of the Selangor State Cassini Grid;	40
(c) Off Ramp to Pahang Road at coordinates N 508.353, E -237.344 of the Selangor State Cassini Grid and ending at coordinates N 267.193, E -276.195 of the Selangor State Cassini Grid;	40
(d) Off Ramp to 9/48A Road at coordinates N 1763.187, E -552.045 of the Selangor State Cassini Grid and ending at coordinates N 1509.234, E -356.671 of the Selangor State Cassini Grid;	40

- (e) Elevated U-turn near Sentul Road at—
- (i) coordinates N 1806.464, E -675.600 of the Selangor State Cassini Grid and ending at coordinates N 1865.075, E -523.663 of the Selangor State Cassini Grid; 30
  - (ii) coordinates N 1865.075, E -523.663 of the Selangor State Cassini Grid and ending at coordinates N 2150.115, E -361.166 of the Selangor State Cassini Grid; and 50
  - (iii) coordinates N 1637.002, E -581.394 of the Selangor State Cassini Grid and ending at coordinates N 1888.967, E -930.961 of the Selangor State Cassini Grid; 40
- (f) Elevated U-turn near Bandar Dalam at—
- (i) coordinates N 2150.115, E -361.166 of the Selangor State Cassini Grid and ending at coordinates N 2607.444, E -388.858 of the Selangor State Cassini Grid; and 50
  - (ii) coordinates N 2607.444, E -388.858 of the Selangor State Cassini Grid and ending at coordinates N 2631.744, E -346.635 of the Selangor State Cassini Grid; 30
- (g) Sentul Pasar Extension Toll Plaza at coordinates N 2631.744, E -346.635 of the Selangor State Cassini Grid and ending at coordinates N 2144.766 E -320.904 of the Selangor State Cassini Grid; 40

*(h)* On and Off Ramps at Taman Sri Setapak at—

- |       |  |    |
|-------|--|----|
| (i)   | coordinates N 2144.766, E -320.904 of the Selangor State Cassini Grid and ending at coordinates N 1993.363, E 29.656 of the Selangor State Cassini Grid;       | 40 |
| (ii)  | coordinates N 1993.363, E 29.656 of the Selangor State Cassini Grid and ending at coordinates N 1750.652, E -368.271 of the Selangor State Cassini Grid; and   | 40 |
| (iii) | coordinates N 2146.053, E -331.325 of the Selangor State Cassini Grid and ending at coordinates N 1599.084, E -534.147 of the Selangor State Cassini Grid; and | 50 |

*(i)* Gombak Road Interchange at—

- |      |   |    |
|------|---|----|
| (i)  | coordinates N 1993.363, E 29.656 of the Selangor State Cassini Grid and ending at coordinates N 2056.757, E 349.226 of the Selangor State Cassini Grid; and | 40 |
| (ii) | coordinates N 2179.605, E 343.332 of the Selangor State Cassini Grid and ending at coordinates N 1993.363, E 29.656 of the Selangor State Cassini Grid.     | 40 |

SECOND SCHEDULE  
MAP 1: MAIN ROAD

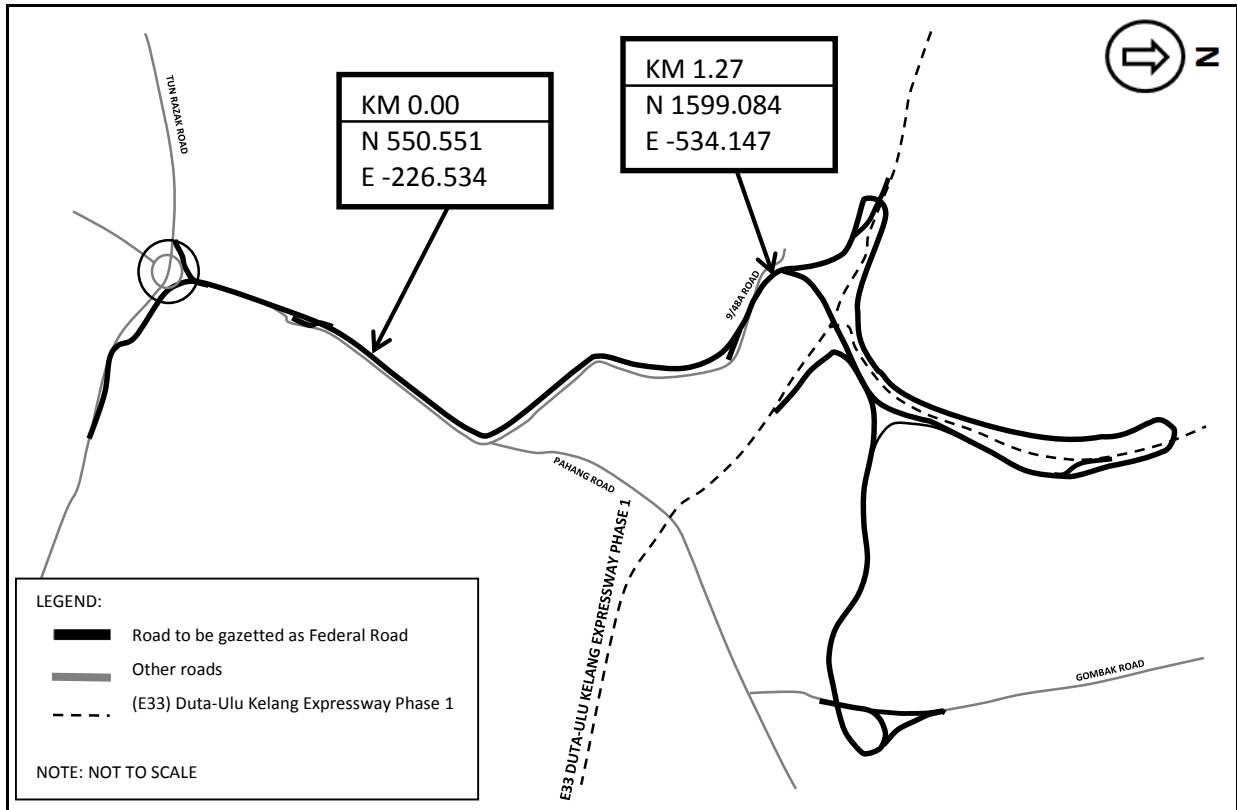

MAP 2: ON RAMP FROM TUN RAZAK ROAD

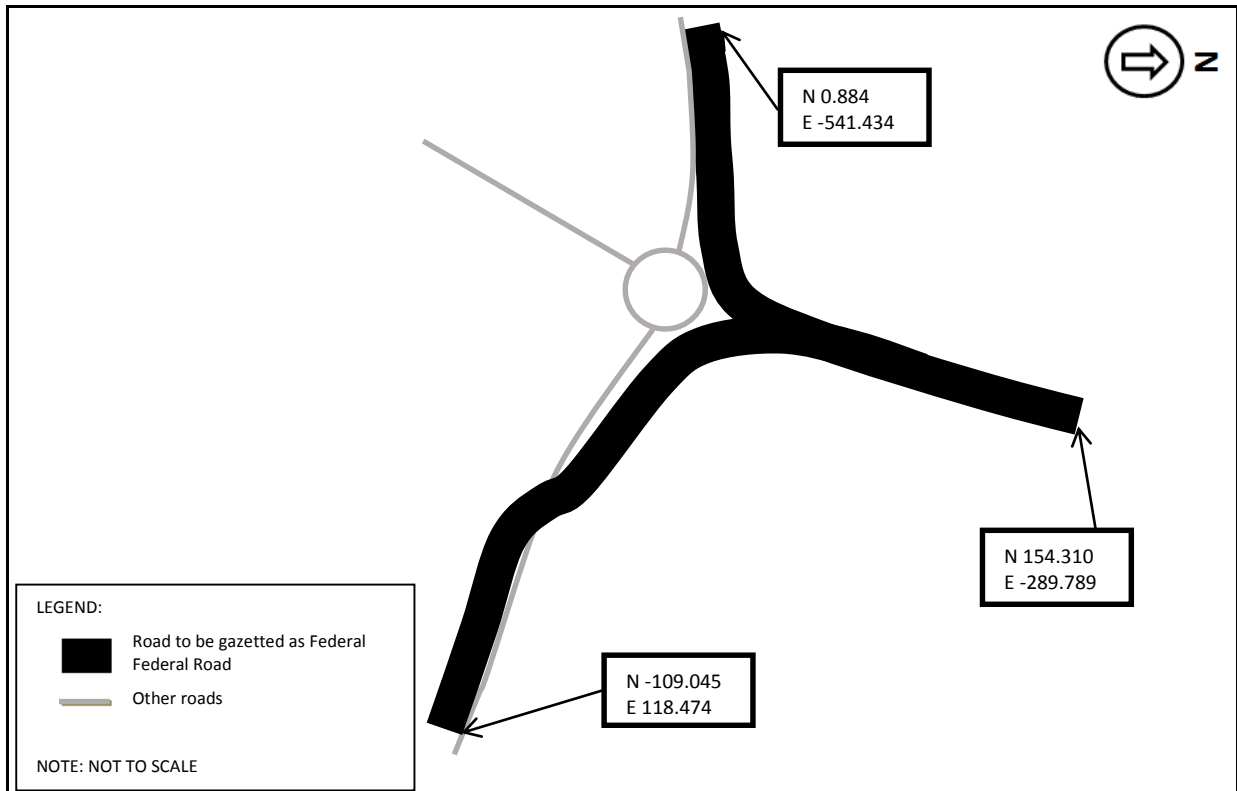

MAP 3: OFF RAMP TO PAHANG ROAD

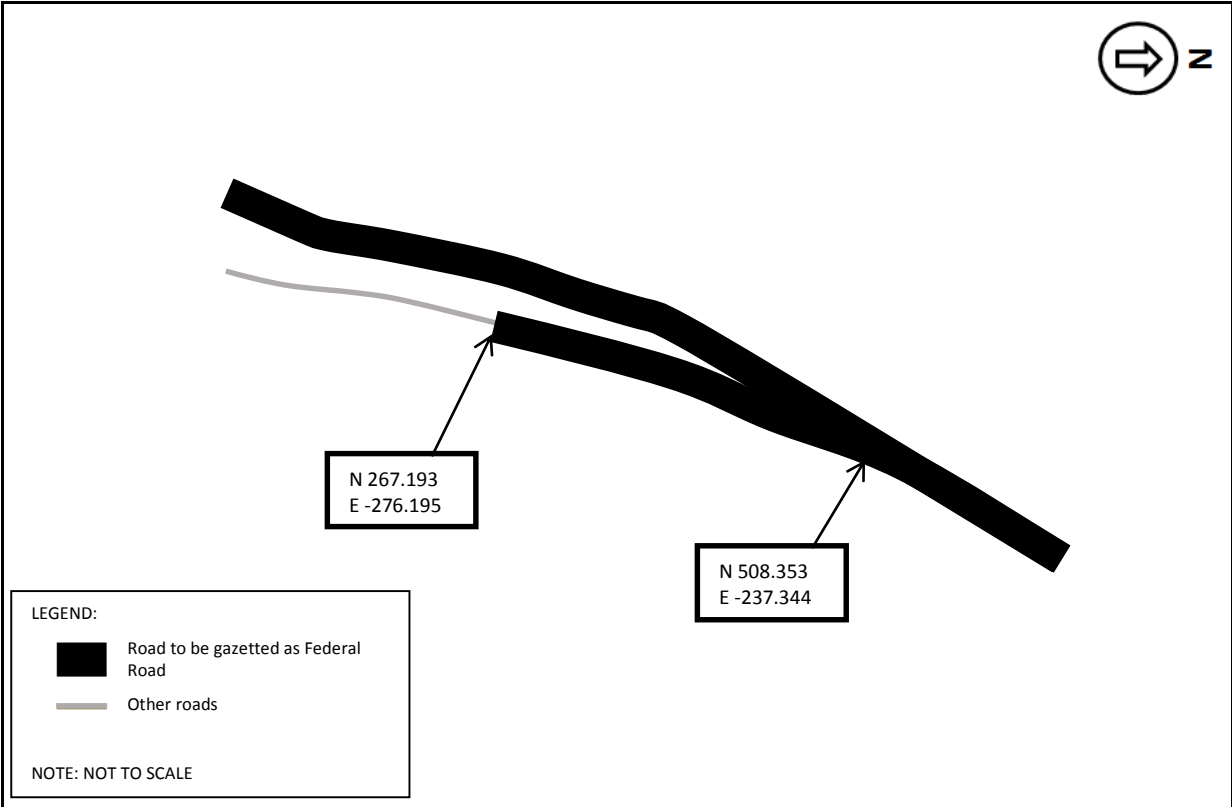

MAP 4: OFF RAMP TO 9/48A ROAD

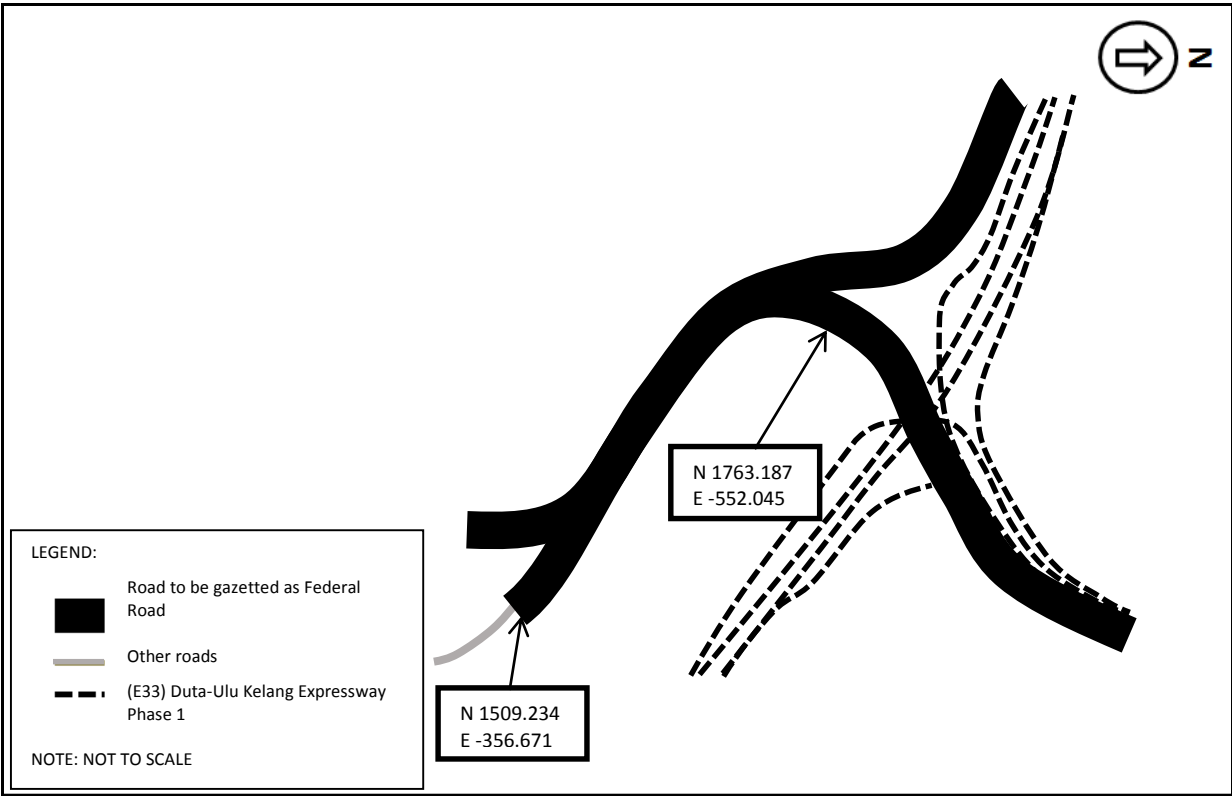

MAP 5: ELEVATED U-TURN NEAR SENTUL ROAD

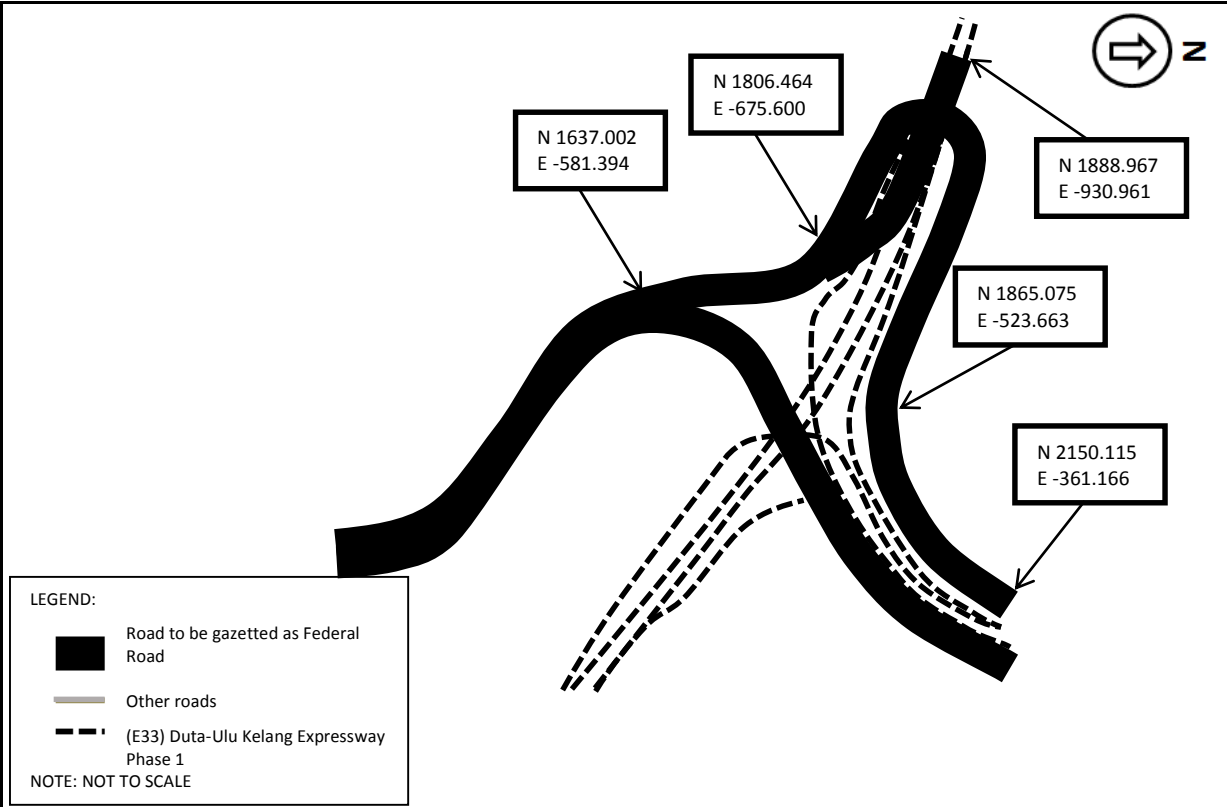

MAP 6: ELEVATED U-TURN NEAR BANDAR DALAM

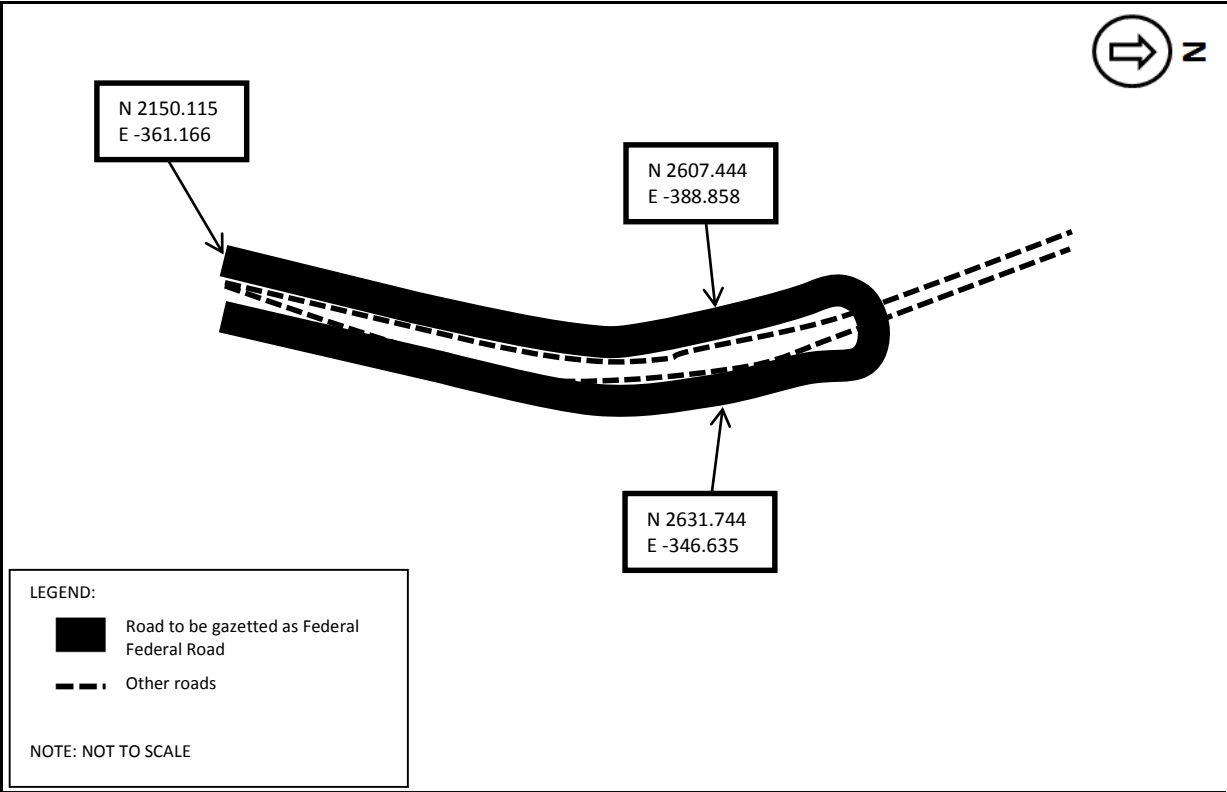

MAP 7: SENTUL PASAR EXTENSION TOLL PLAZA

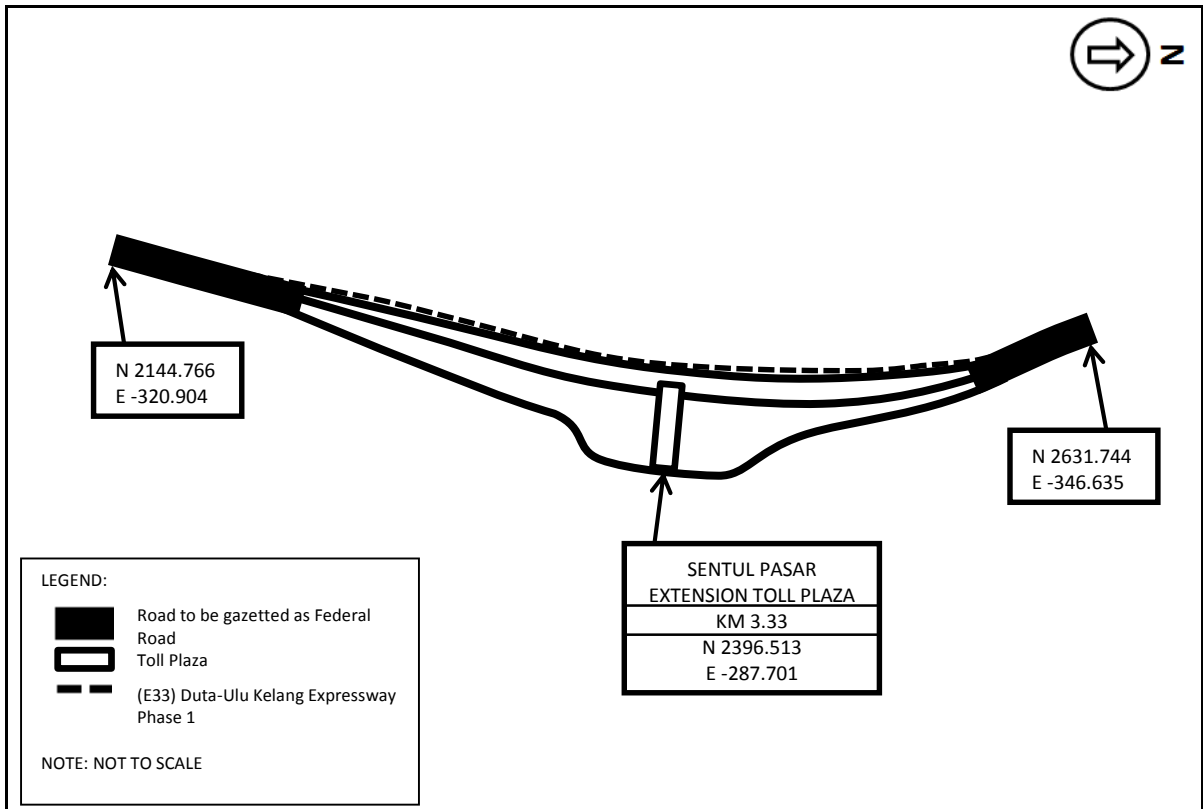

MAP 8: ON AND OFF RAMPS AT TAMAN SRI SETAPAK

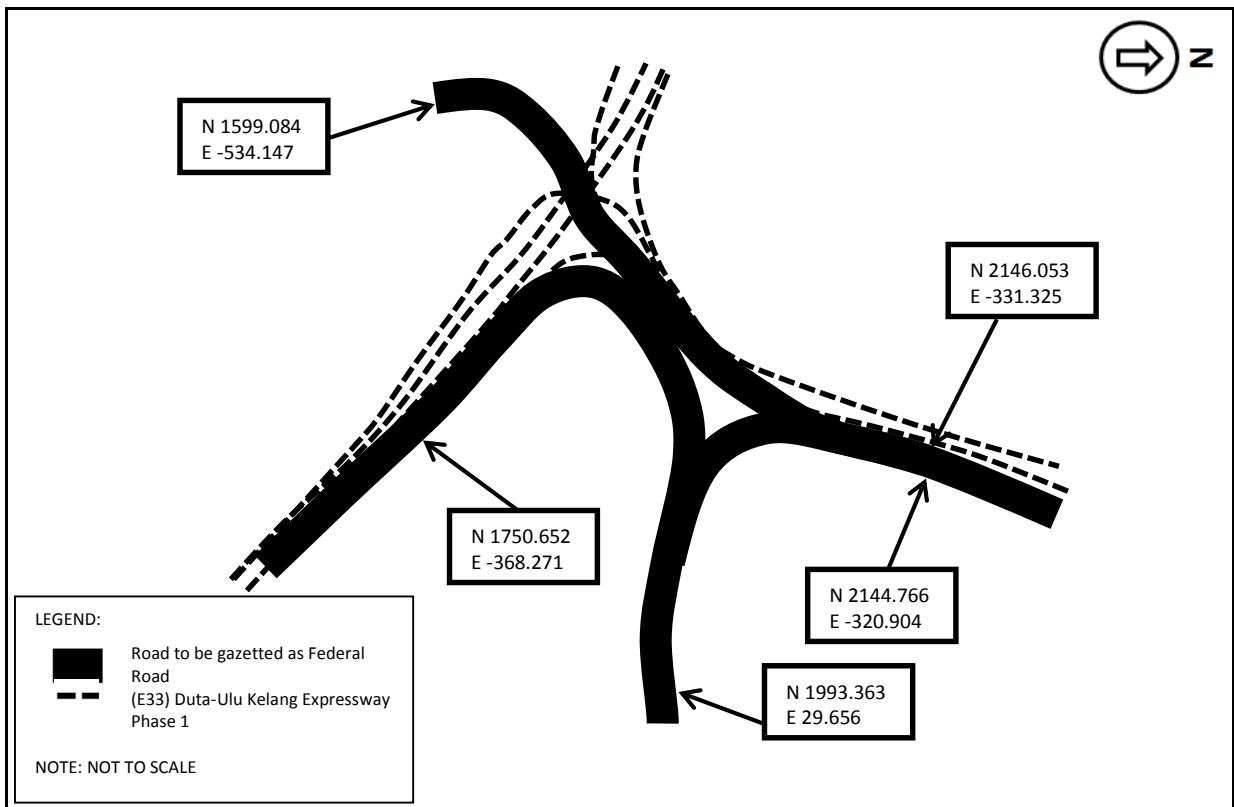

MAP 9: JALAN GOMBAK INTERCHANGE

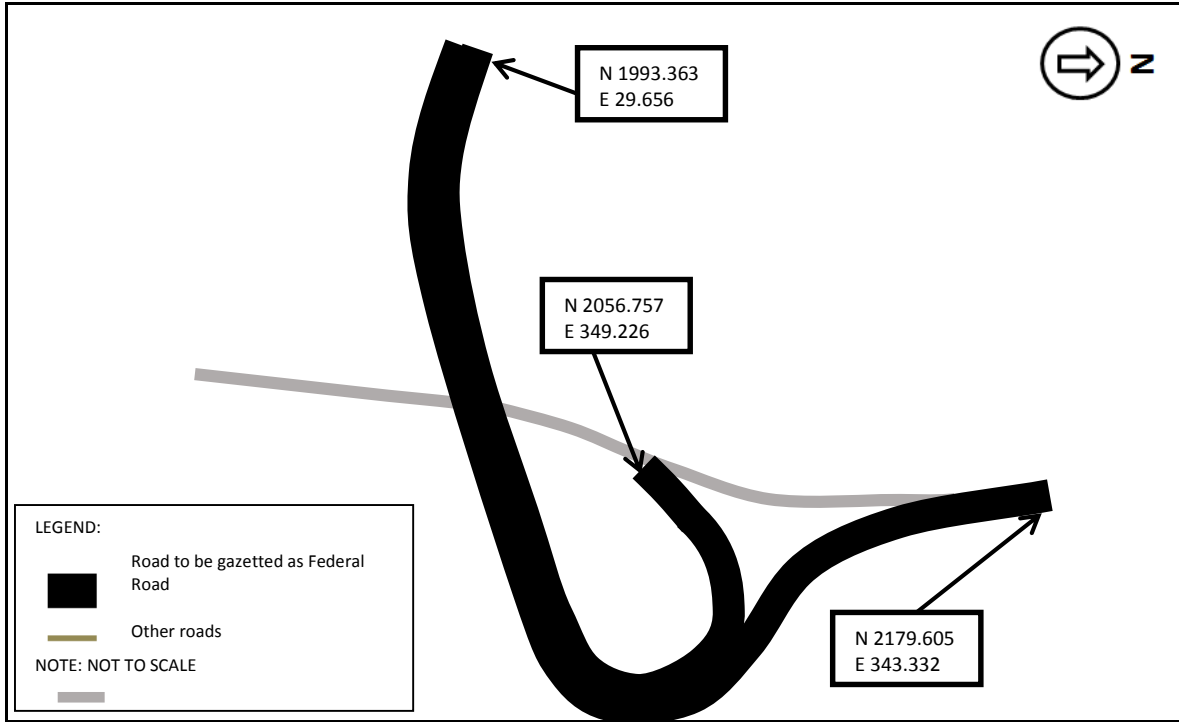

Made 27 September 2017  
[KKR.PUU.110-1/7/32; PN(PU2)391/XXXIV]

DATO' SRI HAJI FADILLAH BIN HAJI YUSOF  
*Minister of Works*