



17 Oktober 2017  
17 October 2017  
P.U. (A) 316

WARTA KERAJAAN PERSEKUTUAN

*FEDERAL GOVERNMENT  
GAZETTE*

PERINTAH HAD LAJU  
(LEBUH RAYA DUTA-ULU KELANG FASA 2  
SRI DAMANSARA LINK) 2017

*SPEED LIMIT (DUTA-ULU KELANG EXPRESSWAY  
PHASE 2 SRI DAMANSARA LINK) ORDER 2017*

DISIARKAN OLEH/  
*PUBLISHED BY*  
JABATAN PEGUAM NEGARA/  
*ATTORNEY GENERAL'S CHAMBERS*

AKTA PENGANGKUTAN JALAN 1987

PERINTAH HAD LAJU (LEBUH RAYA DUTA-ULU KELANG FASA 2  
SRI DAMANSARA LINK) 2017

PADA menjalankan kuasa yang diberikan oleh subseksyen 69(2) Akta Pengangkutan Jalan 1987 [*Akta 333*], Menteri membuat perintah yang berikut:

**Nama dan permulaan kuat kuasa**

1. (1) Perintah ini bolehlah dinamakan **Perintah Had Laju (Lebuh Raya Duta-Ulu Kelang Fasa 2 Sri Damansara Link) 2017**.

(2) Perintah ini mula berkuat kuasa pada 23 Oktober 2017.

**Larangan**

2. (1) Pemanduan suatu kenderaan motor dengan kelajuan yang melebihi had laju yang dinyatakan dalam ruang (2) Jadual Pertama di atas jalan yang dinyatakan dalam ruang (1) Jadual Pertama dilarang.

(2) Jalan dengan had laju yang dinyatakan di bawah subperenggan (1) ditunjukkan dalam peta dalam Jadual Kedua.

## JADUAL PERTAMA

(1)	(2)
<i>Jalan</i>	<i>Had Laju (km/j)</i>
Bahagian jalan yang dikenali sebagai Lebuhraya Duta-Ulu Kelang Fasa 2 Sri Damansara Link yang bermula dari—	
<i>(a)</i> Laluan Utama di kilometer 0.00 di koordinat U 1595.349, T -4521.671 Grid Cassini Negeri Selangor dan berakhir di kilometer 0.46 di koordinat U 1843.619, T -4907.542 Grid Cassini Negeri Selangor;	50
<i>(b)</i> Laluan Utama di kilometer 1.03 di koordinat U 1794.107, T -5544.656 Grid Cassini Negeri Selangor dan berakhir di kilometer 4.06 di koordinat U 2648.726, T -8323.579 Grid Cassini Negeri Selangor;	80
<i>(c)</i> Persimpangan Bertingkat Segambut di—	
<i>(i)</i> koordinat U 1594.108, T -4518.646 Grid Cassini Negeri Selangor dan berakhir di koordinat U 1677.093, T -4302.593 Grid Cassini Negeri Selangor;	40
<i>(ii)</i> koordinat U 1600.942, T -4368.139 Grid Cassini Negeri Selangor dan berakhir di koordinat U 1801.094, T -4208.100 Grid Cassini Negeri Selangor;	40
<i>(iii)</i> koordinat U 1687.035, T -4271.013 Grid Cassini Negeri Selangor dan berakhir di koordinat U 2001.323, T -3842.324 Grid Cassini Negeri Selangor;	40

- (iv) koordinat U 1873.398, T -3997.536 Grid Cassini Negeri Selangor dan berakhir di koordinat U 1585.695, T -4525.732 Grid Cassini Negeri Selangor; 40
- (v) koordinat U 1330.835, T -4462.106 Grid Cassini Negeri Selangor dan berakhir di koordinat U 1545.377, T -4466.002 Grid Cassini Negeri Selangor; dan 40
- (vi) koordinat U 1470.240, T -4424.210 Grid Cassini Negeri Selangor dan berakhir di koordinat U 1872.383, T -4058.503 Grid Cassini Negeri Selangor; 40
- (d) Plaza Tol Segambut di koordinat U 1843.619, T -4907.542 Grid Cassini Negeri Selangor dan berakhir di koordinat U 1794.107, T -5544.656 Grid Cassini Negeri Selangor; 60
- (e) Tanjakan Masuk sepanjang Jalan Lang Emas di koordinat U 2353.863, T -7241.215 Grid Cassini Negeri Selangor dan berakhir di koordinat U 2304.586, T -7005.003 Grid Cassini Negeri Selangor; 40
- (f) Tanjakan Keluar sepanjang Jalan Lang Emas di koordinat U 2253.150, T -6948.232 Grid Cassini Negeri Selangor dan berakhir di koordinat U 2315.533, T -7418.308 Grid Cassini Negeri Selangor; dan 40
- (g) Persimpangan Bertingkat Menjalara di—
- (i) koordinat U 2712.212, T -9384.277 Grid Cassini Negeri Selangor dan berakhir di koordinat U 2649.622, T -8323.128 Grid Cassini Negeri Selangor; 40

- (ii) koordinat U 2647.918, T -8324.174 Grid Cassini Negeri Selangor dan berakhir di koordinat U 2678.991, T -8712.131 Grid Cassini Negeri Selangor; 40
- (iii) koordinat U 2687.718, T -8666.109 Grid Cassini Negeri Selangor dan berakhir di koordinat U 2601.937, T -9268.805 Grid Cassini Negeri Selangor; 40
- (iv) koordinat U 2551.359, T -9100.521 Grid Cassini Negeri Selangor dan berakhir di koordinat U 2493.313, T -9267.490 Grid Cassini Negeri Selangor; 40
- (v) koordinat U 2634.217, T -8990.802 Grid Cassini Negeri Selangor dan berakhir di koordinat U 2885.628, T -8587.775 Grid Cassini Negeri Selangor; 40
- (vi) koordinat U 2733.298, T -8502.631 Grid Cassini Negeri Selangor dan berakhir di koordinat U 2623.286, T -8830.405 Grid Cassini Negeri Selangor; dan 40
- (vii) koordinat U 2712.212, T -9384.276 Grid Cassini Negeri Selangor dan berakhir di koordinat U 2641.197, T -9207.207 Grid Cassini Negeri Selangor. 40

JADUAL KEDUA  
PETA 1: LALUAN UTAMA

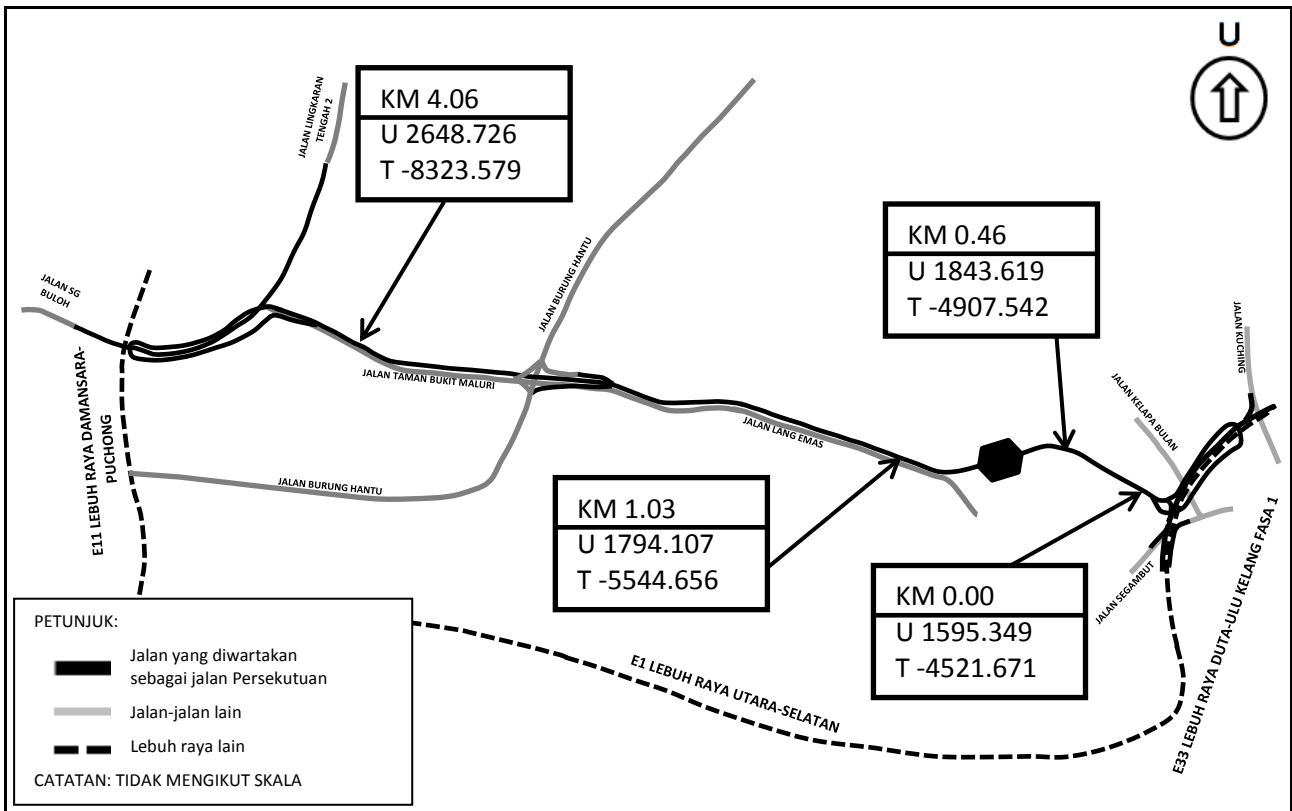

PETA 2: PERSIMPANGAN BERTINGKAT SEGAMPUT

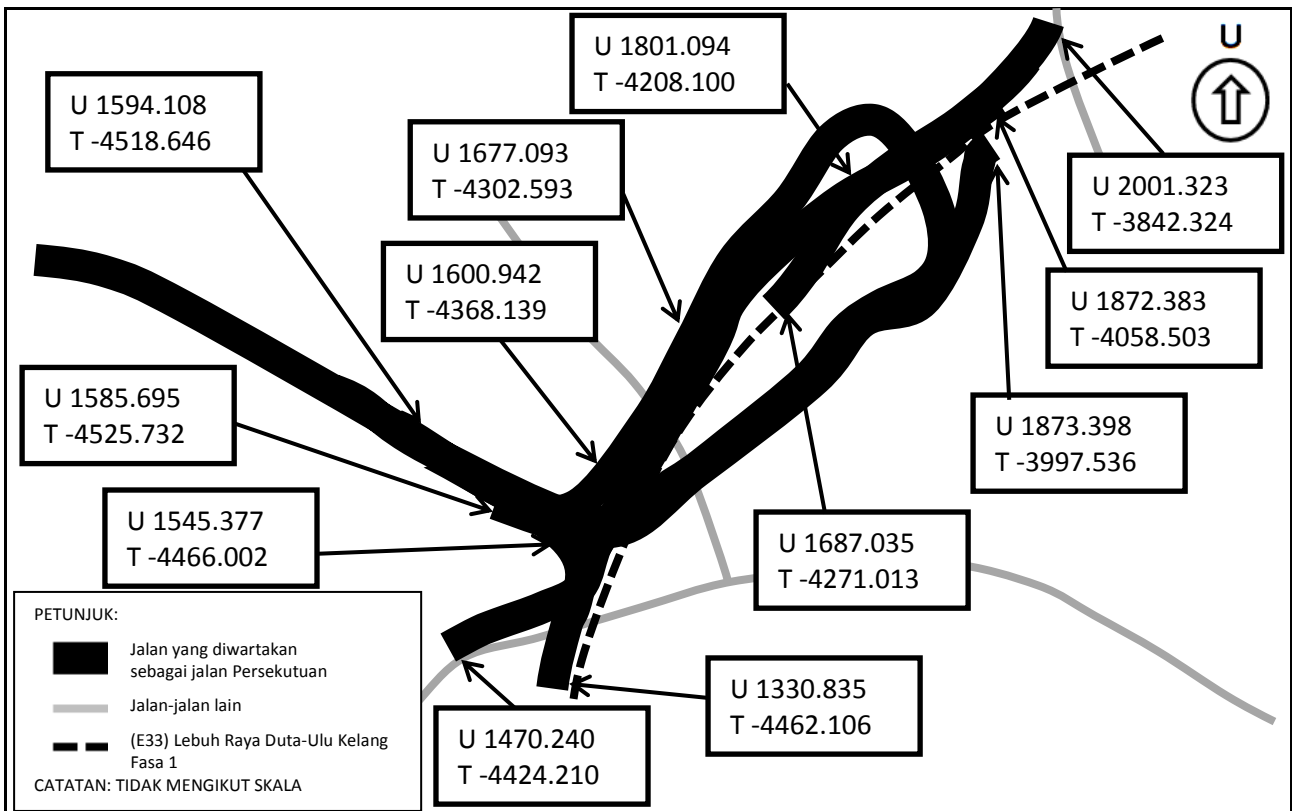

PETA 3: PLAZA TOL SEGAMBUT

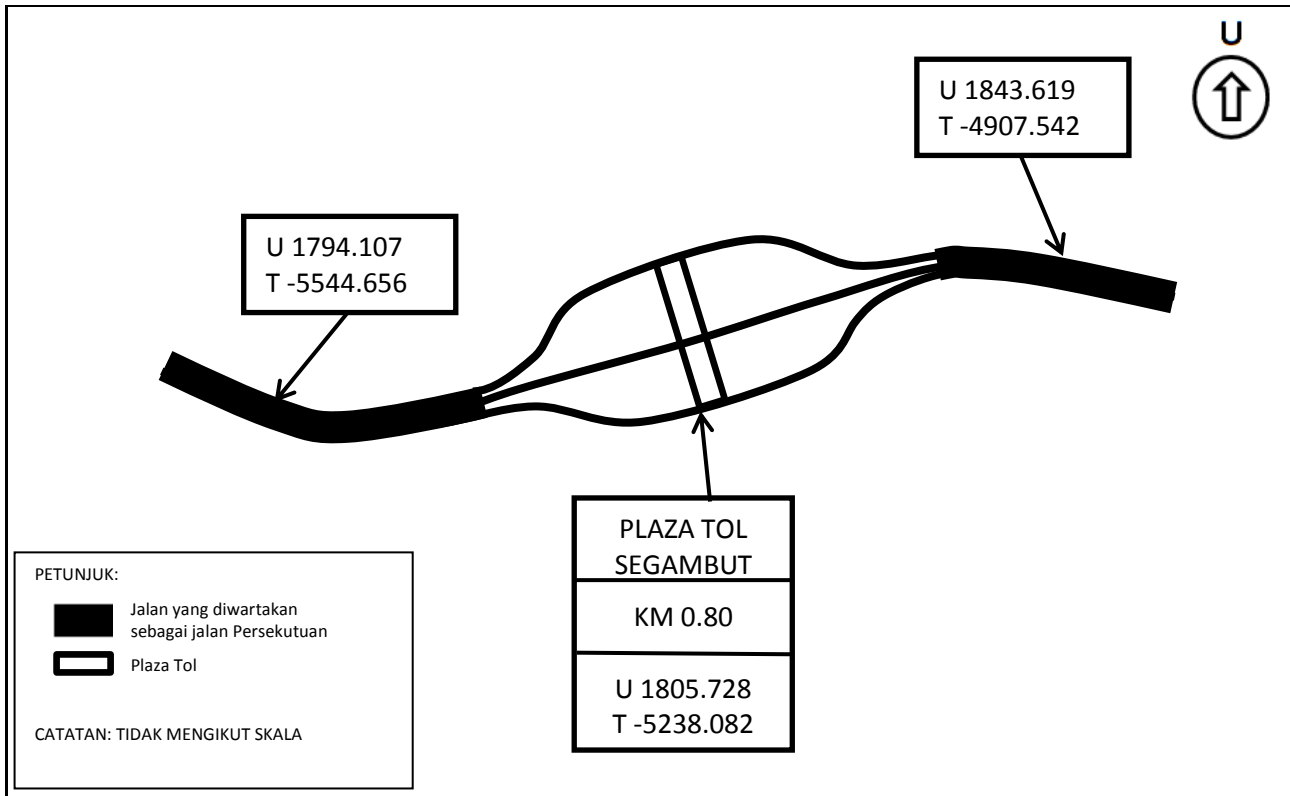

PETA 4: TANJAKAN MASUK DAN KELUAR SEPANJANG JALAN LANG EMAS

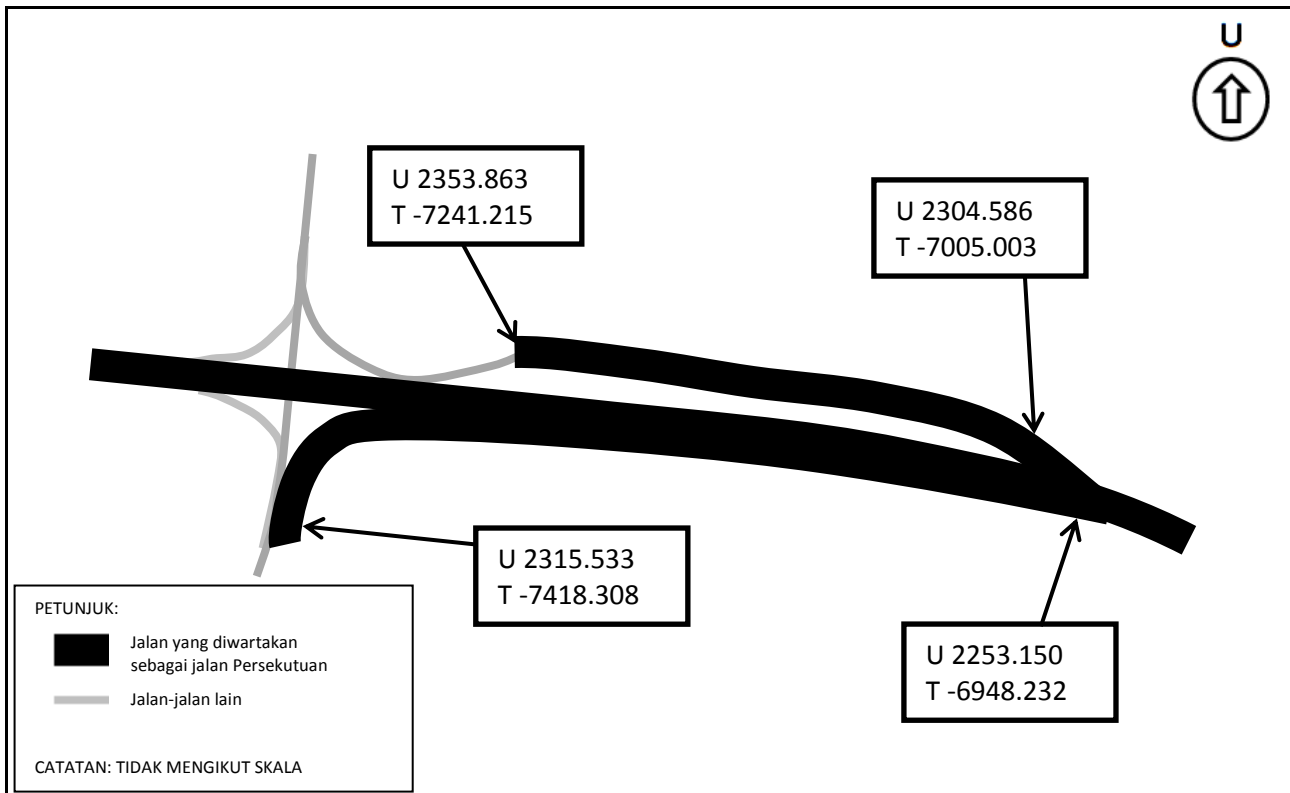

PETA 5: PERSIMPANGAN BERTINGKAT MENJALARA

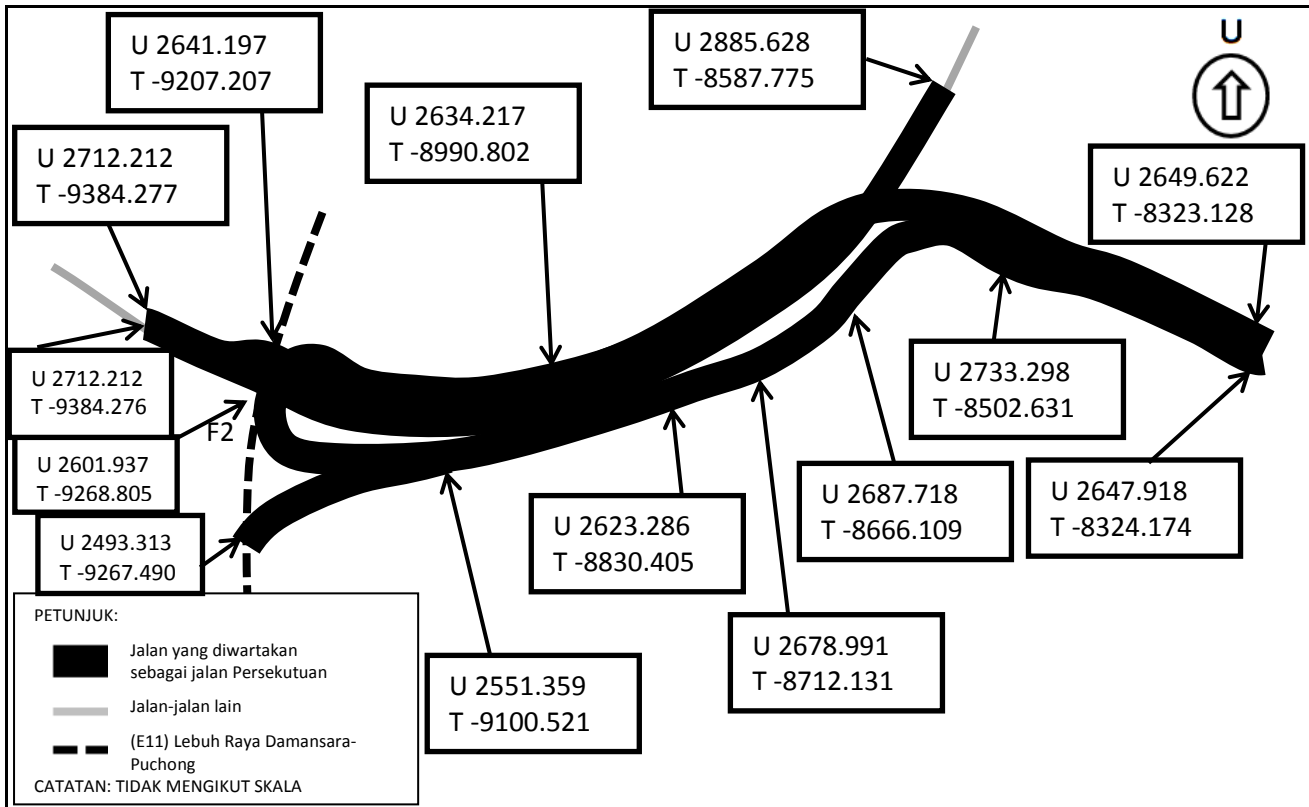

Dibuat 13 Oktober 2017  
 [KKR.PUU.110-1/7/32; PN(PU2)460/XCII]

DATO' SRI HAJI FADILLAH BIN HAJI YUSOF  
 Menteri Kerja Raya

ROAD TRANSPORT ACT 1987

SPEED LIMIT (DUTA-ULU KELANG EXPRESSWAY PHASE 2 SRI DAMANSARA LINK)  
ORDER 2017

IN exercise of the powers conferred by subsection 69(2) of the Road Transport Act 1987 [*Act 333*], the Minister makes the following order:

**Citation and commencement**

1. (1) This order may be cited as the **Speed Limit (Duta-Ulu Kelang Expressway Phase 2 Sri Damansara Link) Order 2017**.

(2) This Order comes into operation on 23 October 2017.

**Prohibition**

2. (1) The driving of a motor vehicle at a speed exceeding the speed limit specified in column (2) of the First Schedule on the road specified in column (1) of the First Schedule is prohibited.

(2) The road with speed limit as specified under subparagraph (1) is shown on the map in the Second Schedule.

## FIRST SCHEDULE

(1)	(2)
<i>Road</i>	<i>Speed Limit (km/h)</i>
That part of the road known as the Duta-Ulu Kelang Expressway Phase 2 Sri Damansara Link commencing from—	
<i>(a)</i> the Main Route at kilometre 0.00 at coordinates N 1595.349, E -4521.671 of the Selangor State Cassini Grid and ending at kilometre 0.46 at coordinates N 1843.619, E -4907.542 of the Selangor State Cassini Grid;	50
<i>(b)</i> the Main Route at kilometre 1.03 at coordinates N 1794.107, E -5544.656 of the Selangor State Cassini Grid and ending at kilometre 4.06 at coordinates N 2648.726, E -8323.579 of the Selangor State Cassini Grid;	80
<i>(c)</i> Segambut Interchange at—	
<i>(i)</i> coordinates N 1594.108, E -4518.646 of the Selangor State Cassini Grid and ending at coordinates N 1677.093, E -4302.593 of the Selangor State Cassini Grid;	40
<i>(ii)</i> coordinates N 1600.942, E -4368.139 of the Selangor State Cassini Grid and ending at coordinates N 1801.094, E -4208.100 of the Selangor State Cassini Grid;	40
<i>(iii)</i> coordinates N 1687.035, E -4271.013 of the Selangor State Cassini Grid and ending at coordinates N 2001.323, E -3842.324 of the Selangor State Cassini Grid;	40

- |      |   |    |
|------|---|----|
| (iv) | coordinates N 1873.398, E -3997.536 of the Selangor State Cassini Grid and ending at coordinates N 1585.695, E -4525.732 of the Selangor State Cassini Grid;                                      | 40 |
| (v)  | coordinates N 1330.835, E -4462.106 of the Selangor State Cassini Grid and ending at coordinates N 1545.377, E -4466.002 of the Selangor State Cassini Grid; and                                  | 40 |
| (vi) | coordinates N 1470.240, E -4424.210 of the Selangor State Cassini Grid and ending at coordinates N 1872.383, E -4058.503 of the Selangor State Cassini Grid;                                      | 40 |
| (d)  | Segambut Toll Plaza at coordinates N 1843.619, E -4907.542 of the Selangor State Cassini Grid and ending at coordinates N 1794.107, E -5544.656 of the Selangor State Cassini Grid;               | 60 |
| (e)  | On Ramp along Lang Emas Road at coordinates N 2353.863, E -7241.215 of the Selangor State Cassini Grid and ending at coordinates N 2304.586, E -7005.003 of the Selangor State Cassini Grid;      | 40 |
| (f)  | Off Ramp along Lang Emas Road at coordinates N 2253.150, E -6948.232 of the Selangor State Cassini Grid and ending at coordinates N 2315.533, E -7418.308 of the Selangor State Cassini Grid; and | 40 |
| (g)  | Menjalara Interchange at —  |    |
| (i)  | coordinates N 2712.212, E -9384.277 of the Selangor State Cassini Grid and ending at coordinates N 2649.622, E -8323.128 of the Selangor State Cassini Grid;                                      | 40 |

- (ii) coordinates N 2647.918, E -8324.174 of the Selangor State Cassini Grid and ending at coordinates N 2678.991, E -8712.131 of the Selangor State Cassini Grid; 40
- (iii) coordinates N 2687.718, E -8666.109 of the Selangor State Cassini Grid and ending at coordinates N 2601.937, E -9268.805 of the Selangor State Cassini Grid; 40
- (iv) coordinates N 2551.359, E -9100.521 of the Selangor State Cassini Grid and ending at coordinates N 2493.313, E -9267.490 of the Selangor State Cassini Grid; 40
- (v) coordinates N 2634.217, E -8990.802 of the Selangor State Cassini Grid and ending at coordinates N 2885.628, E -8587.775 of the Selangor State Cassini Grid; 40
- (vi) coordinates N 2733.298, E -8502.631 of the Selangor State Cassini Grid and ending at coordinates N 2623.286, E -8830.405 of the Selangor State Cassini Grid; and 40
- (vii) coordinates N 2712.212, E -9384.276 of the Selangor State Cassini Grid and ending at coordinates N 2641.197, E -9207.207 of the Selangor State Cassini Grid. 40

SECOND SCHEDULE

MAP 1: MAIN ROAD

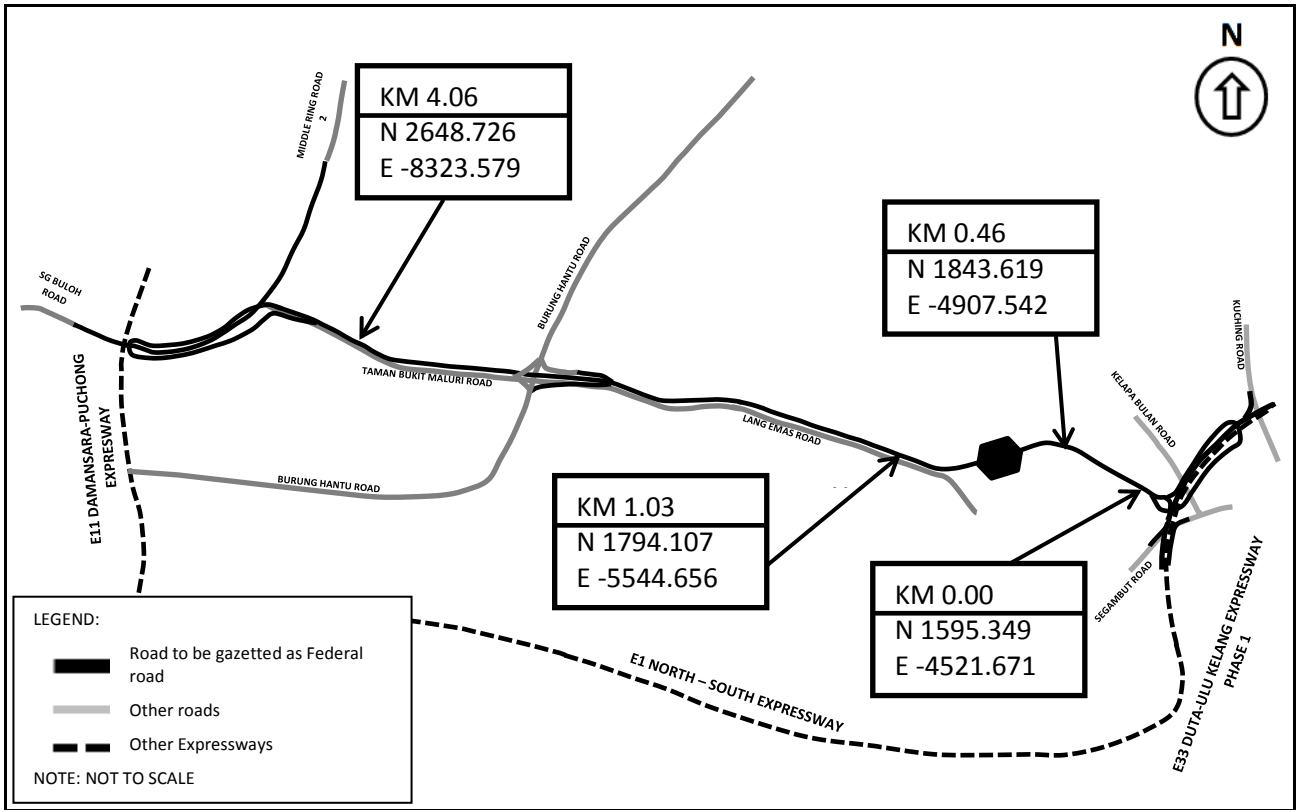

MAP 2: SEGAMBUT INTERCHANGE

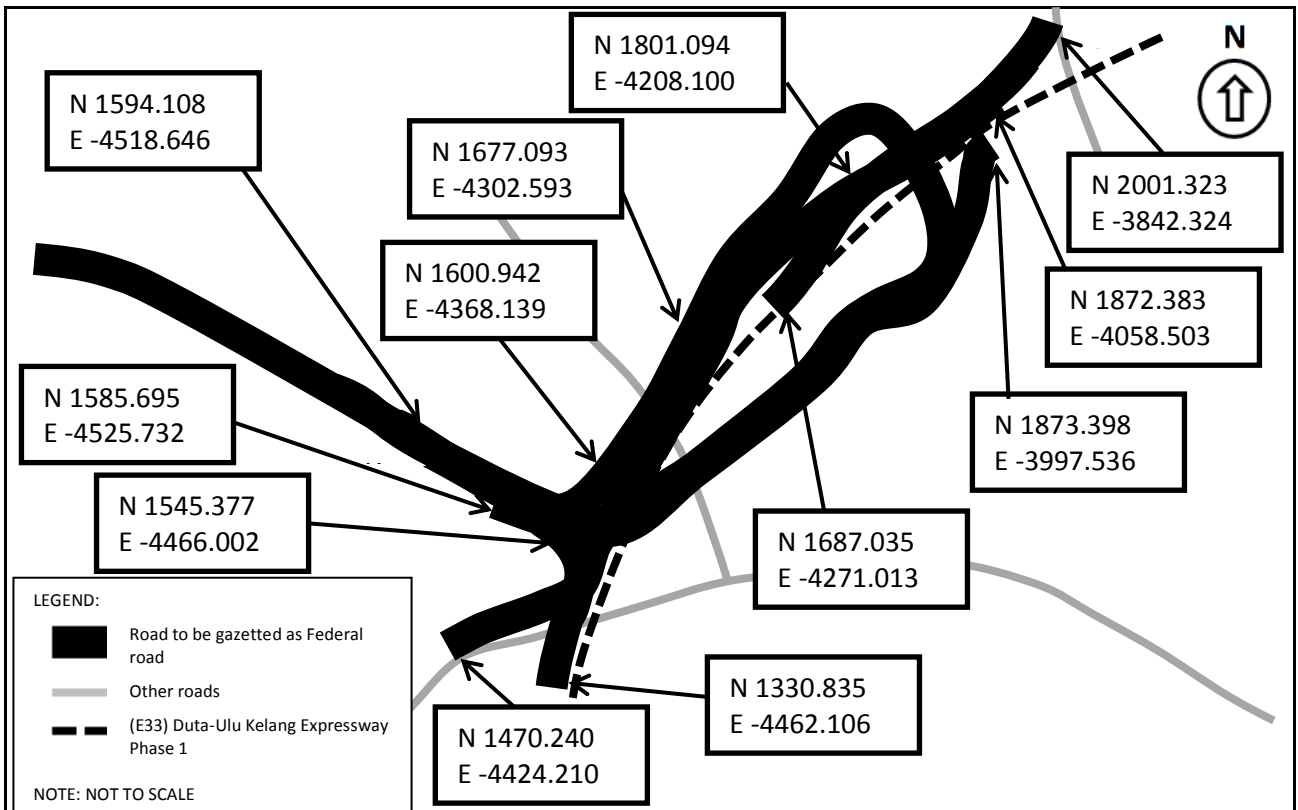

MAP 3: SEGAMBUT TOLL PLAZA

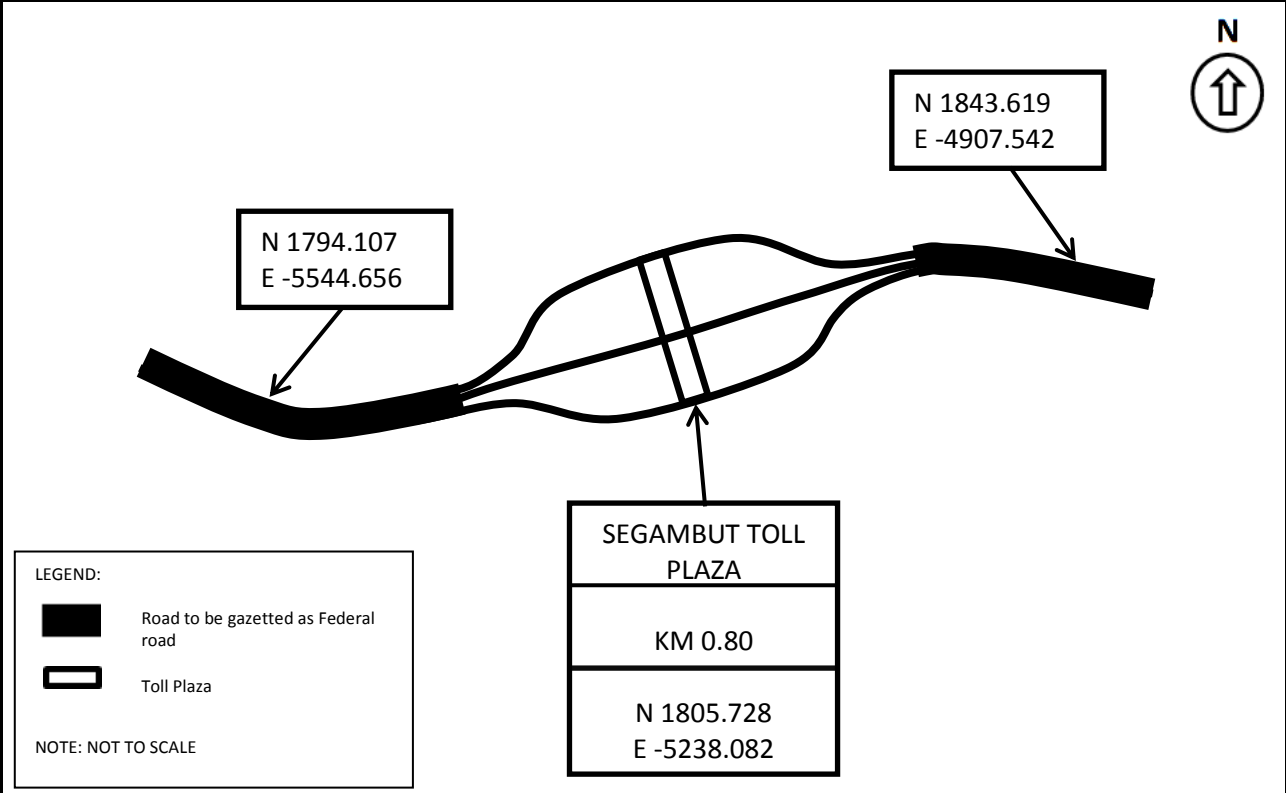

MAP 4: ON AND OFF RAMPS ALONG LANG EMAS ROAD

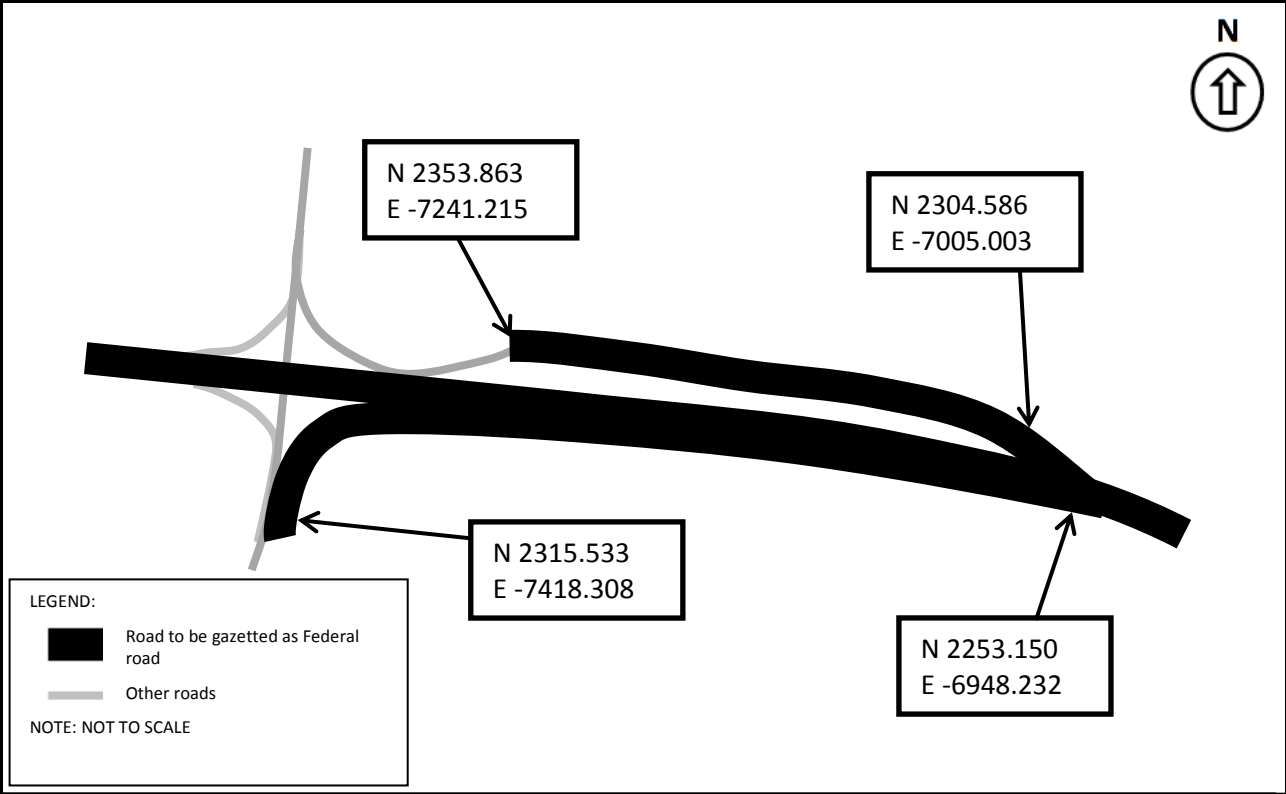

MAP 5: MENJALARA INTERCHANGE

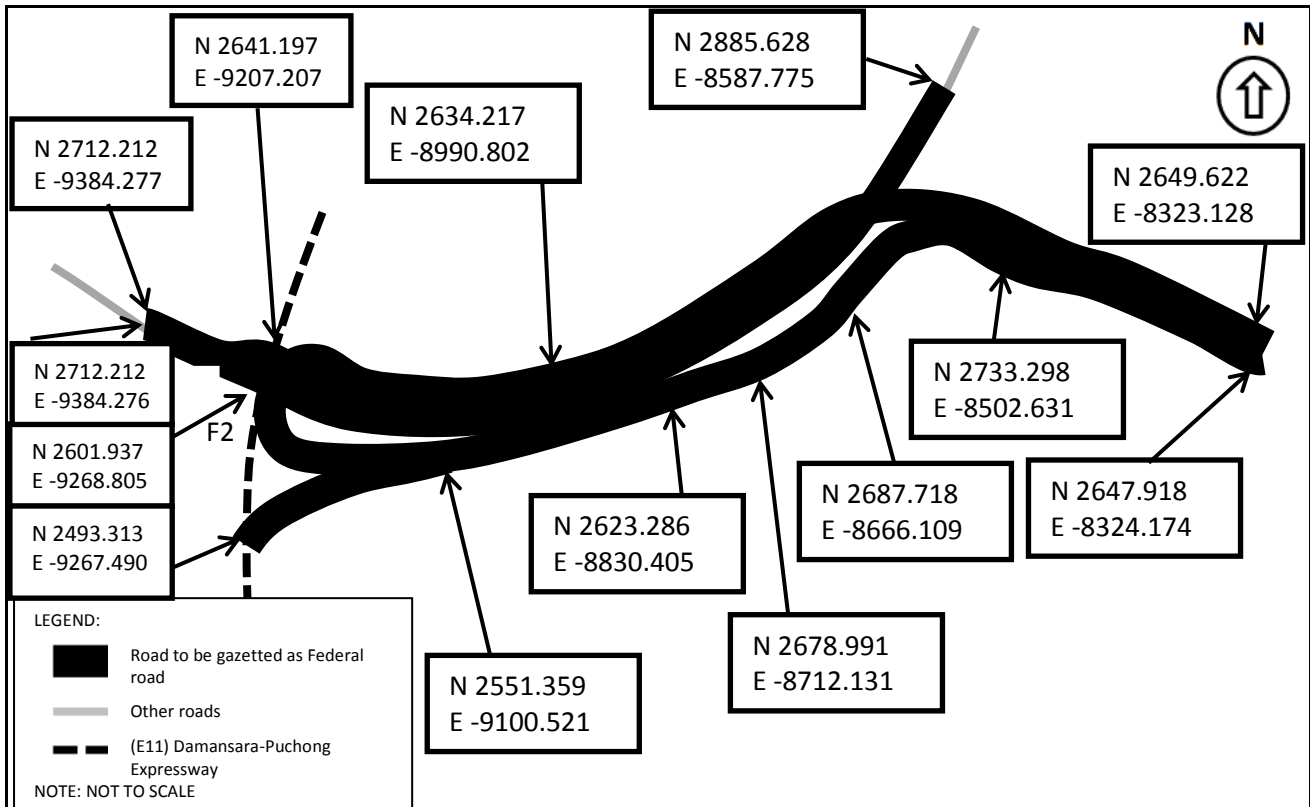

Made 13 October 2017  
 [KKR.PUU.110-1/7/32; PN(PU2)460/XCII]

DATO' SRI HAJI FADILLAH BIN HAJI YUSOF  
 Minister of Works